

FURC

Florida Undergraduate Research Conference



2019



Welcome

Welcome to the 2019 Florida Undergraduate Research Conference (FURC) at the University of North Florida! UNF, and especially the Office of Undergraduate Research, are excited to welcome you to our eco-friendly campus, surrounded by a nature preserve, beautiful lakes, and nature trails.

This year, over 380 posters will be presented to more than 600 participants from across the state of Florida. During the conference, you will have the opportunity to attend poster sessions, network with graduate school recruiters, and attend professional development workshop sessions.

Thank you to everyone who made this possible and I hope you enjoy FURC 2019!

- Kelsey Eagen
Conference Coordinator

Conference Schedule

Friday, February 22

Time	Event	Location
5 - 8 p.m.	Registration and Reception	Boathouse and Osprey Plaza
7 - 7:45 p.m.	Keynote Speaker: Dr. John Kantner	John Delaney Student Union

Saturday, February 23

Time	Event	Location
7:30 - 8:30 p.m.	Check-in and Breakfast	Fieldhouse
8:30 - 9:30 a.m.	Poster Session I	Fieldhouse
9:45 - 10:30 a.m.	Workshop Session I	John Delaney Student Union West 3rd floor
10:45 - 11:45 a.m.	Poster Session II	Fieldhouse
Noon - 1:30 p.m.	Lunch	John Delaney Student Union Osprey Cafe
1:45 - 2:45 p.m.	Poster Session III	Fieldhouse
3 - 3:45 p.m.	Workshop II	John Delaney Student Union West 3rd floor
4 - 5:00 p.m.	Poster Session IV	Fieldhouse

*A campus map is located in the back of the program.

Keynote Speaker: Dr. John Kantner



Associate Vice President for Research &
Dean of the Graduate School

University of North Florida

John Kantner, Ph.D., was appointed Associate Vice President for Research and Dean of the Graduate School of the University of North Florida in 2014. Prior to that, he was Vice President for Academic & Institutional Advancement at the School for Advanced Research in Santa Fe, NM, an independent “think tank” for the social sciences and humanities. From 1999 to 2006, Dr. Kantner was a faculty member in the Department of Anthropology & Geography at Georgia State University in Atlanta, where he achieved the rank of associate professor with tenure prior to his departure.

Dr. Kantner is an anthropological archaeologist with a broad background in several disciplines. He received his doctorate from the University of California–Santa Barbara, where he studied archaeology, anthropology, geography,

geochemistry, behavioral economics, and evolutionary theory. His research has focused on ancient peoples of the U.S. Southwest, but he also has collaborated on archaeological investigations in Central America, South America, the U.S. Plains, U.S. Southeast, and the U.S. Rocky Mountains, on projects ranging from explaining political violence in ancient societies to modeling human movement across digital landscapes and extracting human fingerprints from 1,000-year-old pottery. Dr. Kantner has been recognized with numerous grants and awards, including one of the only five NSF CAREER grants ever awarded to an archaeologist, a Presidential Recognition Award by the Society for American Archaeology, and the top award in an international multimedia competition sponsored by Apple Computer. He has been invited to lecture and appear in documentaries globally, including on the Discovery, History, Smithsonian, and Travel channels.



Workshop Session I

RESEARCHING GRADUATE PROGRAMS

Lee Gordon, Perdue University

3703A

This workshop will educate how participants can effectively research available programs, learn about free travel to national graduate school recruiting fairs, hear what matters most to others searching for graduate programs, and to locate data points that matter most to them in finding the perfect fit. Participants will also learn about application fee waivers, contacting faculty about funding, and how all of this comes into play in making a decision of where to apply for an advanced degree.

PLAYING TO YOUR STRENGTHS: KNOW ALL OF YOUR OPTIONS WHEN APPLYING TO GRADUATE SCHOOL

Katelyn Haschke, Fort Hays State University

3703B

This session is intended for all undergraduate students planning to apply to graduate school. The process of applying is both an exciting and stressful time; the purpose of this interactive workshop is to discuss how to highlight strengths as a student, researcher, and young professional when applying to various graduate programs. Two main topics will be discussed. First, building a strong application by: crafting an effective personal statement, knowing who to request a letter of recommendation from, and organizing your curriculum vitae to stand out among peers. Second, the importance of considering programs outside of your Bachelor's degree field as a way to broaden interdisciplinary expertise and set yourself up for success as you plan for a future job past graduate school. Time will be reserved for questions from attendees.

WHAT STEM STUDENTS NEED TO KNOW ABOUT INTELLECTUAL PROPERTY

Christopher Turoski, University of Minnesota

3703C

From this session you will learn how IP and patents can support your career as a business person, academic, or another alternative career path. A STEM degree prepares you for many career roles in business and academia. In business, IP issues help distinguish you from your peers, and help contribute to the bottom line. In academia, you get ahead by navigating a complex scheme of grants, publications, and teamwork, which can undercut or complement obtaining IP for your work. In addition to careers in business and academics, you may be interested in an alternative career path such a patent lawyer or patent agent. This session will cover these topics (i.e. IP/patents as a business, research and career tool).

TIPS, TRICKS AND ADVICE ON APPLYING TO GRADUATE SCHOOL

Liani Ramos, New York University

3703D

My presentation covers all the common questions and concerns that students have regarding applying to graduate school but it's also packed with tips, tricks and advice directly from an admissions officer from NYU. It will go over an ideal timeline, best practices, tips and insider information about admissions at the graduate level, what types of things faculty look for, finding funding and much more.

9:45 - 10:30 AM

Workshop Session I

YOUR PATH TO GRADUATE SCHOOL & CAREER SUCCESS STARTS TODAY

Betsy Crawford, Florida State University

3804

As an undergraduate student involved in research, you are already a strong candidate for competitive graduate school programs. Learn how earning a graduate degree can support career success and the steps to take now to boost your application. The workshop includes an overview of resources available to create an outstanding application and a preparation timeline that will keep you ahead of the game.

APPROACHING GRADUATE RESEARCH: ARCHIVAL RESEARCH, DATABASES, AND DIGITAL HUMANITIES TECHNIQUES

Louise Kane, University of Central Florida

3805

This workshop offers a practical, 'hands on' guide for undergraduate researchers who want to understand more about how to conduct archival research, and how database searching and digital humanities techniques can make this task easier. Designed to prepare undergraduate students for the types of research they'll be undertaking at graduate school, the workshop offers a foundation for learning the major ways to begin archival research. This includes how to search for 'hard to find' texts using online databases and archives, learning how to use 'finding aids', and also learning how Digital Humanities techniques can help students to 'map out' and visualize their research as it begins to progress. The course is designed for beginners: you do not need any experience of searching databases, or conducting archival research, and you also don't need any prior familiarity with Digital Humanities.

BUILDING ACADEMIC RELATIONSHIPS

Lindsey Weglarz, University of Central Florida

3806

Academic relationships play a very important role in not only the graduate admissions process, but also a student's future career path. A great relationship with a faculty mentor can provide opportunities for years beyond college, whether through research experiences, introductions to colleagues, or even just by providing good advice. In the graduate admissions process, recommendation letters from current faculty mentors can play a determining role in whether a student is admitted, while relationships cultivated in the prospective program can also increase the chances of admission. This workshop provides strategies for building relationships with current faculty and networking with faculty at other institutions, and as well as discussing best practices for communicating with faculty during the graduate admissions process.

9:45 - 10:30 AM

Workshop Session I

HOW TO: COPE WITH FEEDBACK ON YOUR RESEARCH

Aubrey Kuperman, University of Central Florida

3601

Have you ever gotten a draft back and felt defeated by all of the notes or comments? Or been unsure of how to improve? Join this session to learn more about what can make feedback so hard and pick up concrete strategies to improve your ability to process it and improve your work.

MAKING THE MOST OF COURSE PROJECTS

Matthew Eicholtz, Florida Southern College

3602

For many students, course projects elicit negative feelings of fear, reluctance, and uncertainty. What if I get stuck with peers who are difficult to work with? How will I choose a good idea to pursue? Will I receive a poor grade if my idea does not work as expected? How can I do well if the grading criteria seems so vague? Will this even matter for my career if I am only a freshman or sophomore? Perhaps other students view the ambiguity of projects as a chance to settle for the minimum amount of effort required or to rely on other group members to do the brunt of the work. In this workshop, we will explore how course projects can be a critical part of your academic growth and offer tips and tricks for maximizing their value for your future career. Course projects are a great opportunity to investigate a topic of personal interest or gain traction in a field that students wish to pursue long-term. Projects also allow students to demonstrate relevant skills for conducting research; indeed, successful projects may launch research opportunities with the professor teaching the class. We will discuss ways to leverage course projects for your career search such as highlighting them on your resume or talking about difficult challenges in an interview. Finally, instructors may benefit from reflecting on how to effectively integrate projects in their courses to prepare students for success in research and beyond.

9:45 - 10:30 AM

Workshop Session II

YOUR PATH TO GRADUATE SCHOOL & CAREER SUCCESS STARTS TODAY

Betsy Crawford, Florida State University

3703A

As an undergraduate student involved in research, you are already a strong candidate for competitive graduate school programs. Learn how earning a graduate degree can support career success and the steps to take now to boost your application. The workshop includes an overview of resources available to create an outstanding application and a preparation timeline that will keep you ahead of the game.

TIPS, TRICKS AND ADVICE ON APPLYING TO GRADUATE SCHOOL

Liani Ramos, New York University

3703B

My presentation covers all the common questions and concerns that students have regarding applying to graduate school but it's also packed with tips, tricks and advice directly from an admissions officer from NYU. It will go over an ideal timeline, best practices, tips and insider information about admissions at the graduate level, what types of things faculty look for, finding funding and much more.

WHAT STEM STUDENTS NEED TO KNOW ABOUT INTELLECTUAL PROPERTY

Christopher Turoski, University of Minnesota

3703C

From this session you will learn how IP and patents can support your career as a business person, academic, or another alternative career path. A STEM degree prepares you for many career roles in business and academia. In business, IP issues help distinguish you from your peers, and help contribute to the bottom line. In academia, you get ahead by navigating a complex scheme of grants, publications, and teamwork, which can undercut or complement obtaining IP for your work. In addition to careers in business and academics, you may be interested in an alternative career path such a patent lawyer or patent agent. This session will cover these topics (i.e. IP/patents as a business, research and career tool).

BUILDING ACADEMIC RELATIONSHIPS

Lindsey Weglarz, University of Chicago

3703D

Academic relationships play a very important role in not only the graduate admissions process, but also a student's future career path. A great relationship with a faculty mentor can provide opportunities for years beyond college, whether through research experiences, introductions to colleagues, or even just by providing good advice. In the graduate admissions process, recommendation letters from current faculty mentors can play a determining role in whether a student is admitted, while relationships cultivated in the prospective program can also increase the chances of admission. This workshop provides strategies for building relationships with current faculty and networking with faculty at other institutions, and as well as discussing best practices for communicating with faculty during the graduate admissions process.

3:00 - 3:45 PM

Workshop Session II

HOW TO: GET A GREAT LETTER OF RECOMMENDATION

Aubrey Kuperman, University of Central Florida

3804

Letters of recommendation are a requirement for graduate school and professional schools, scholarships, internships, summer research experience, and sometimes the job search. Learn more about when and how to ask for letters of recommendation, and how to follow up with those who write them for you.

SUMMER OFF-CAMPUS RESEARCH EXPERIENCES

Kimberly Schneider, PhD, University of Central Florida

3805

Summer is a great time to participate in research and there are numerous programs available to students away from their home institution. Summer programs are available at numerous universities and research institutions. Opportunities are available nationally and internationally and many provide a stipend, travel costs, housing, and/or board. Applications open in late fall and deadlines occur from early December through the end of March. Opportunities exist for all majors but more are available for students in the science and engineering areas. Fall and spring semester opportunities also exist. This workshop will provide an overview of these opportunities, information on how to create a strong application, and resources to help students through the process.

A DEBRIEFING OF THE FIRST ANNUAL FLORIDA UNDERGRADUATE RESEARCH LEADERSHIP SUMMIT

Sophia Anagnostis, Stephanie Ciricillo, Katherine Ngo, University of Florida

3806

On January 23-24, over 40 student undergraduate research (UR) leaders from 16 Florida institutions met to share best practices, and to discuss ways to enhance the undergraduate research experience across the state. Established UR student groups provided guidance to others interested in forming/refining a group on their campus. The Summit included workshops on setting up a student-run Center for UR, Peer Mentorship, student developed campus UR activities, and marketing UR. In addition, round table discussions provided a venue for all participants to discuss topics pertinent to their campuses. This workshop will presents highlights and recommendations that were developed during this summit. We invite all undergraduate research student leaders to attend. Plans to continue this state-wide student-led conference will also be discussed.

FUNDING YOUR GRADUATE EDUCATION

Albert Hoyt, Florida International University

3601

More than 2.25 million people apply to graduate programs in the United States every year and many of these applicants are looking for ways to fund their degree. From assistantships to fellowships, learn the basics of funding your graduate education. Don't pay for your graduate degree on your own!

3:00 - 3:45 PM

Workshop Session II

RESEARCHING GRADUATE PROGRAMS

Lee Gordon, Perdue University

3602

This workshop will educate how participants can effectively research available programs, learn about free travel to national graduate school recruiting fairs, hear what matters most to others searching for graduate programs, and to locate data points that matter most to them in finding the perfect fit. Participants will also learn about application fee waivers, contacting faculty about funding, and how all of this comes into play in making a decision of where to apply for an advanced degree.

PLAYING TO YOUR STRENGTHS: KNOW ALL OF YOUR OPTIONS WHEN APPLYING TO GRADUATE SCHOOL

Katelyn Haschke, Fort Hays State University

3605

This session is intended for all undergraduate students planning to apply to graduate school. The process of applying is both an exciting and stressful time; the purpose of this interactive workshop is to discuss how to highlight strengths as a student, researcher, and young professional when applying to various graduate programs. Two main topics will be discussed. First, building a strong application by: crafting an effective personal statement, knowing who to request a letter of recommendation from, and organizing your curriculum vitae to stand out among peers. Second, the importance of considering programs outside of your Bachelor's degree field as a way to broaden interdisciplinary expertise and set yourself up for success as you plan for a future job past graduate school. Time will be reserved for questions from attendees.

3:00 - 3:45 PM

Poster Session I

1. OPTIMIZATION OF ULTRAHIGH PRESSURE EXTRACTION METHOD USING STATISTICAL ANALYTICAL TECHNIQUES
Sonali Pandey, Siddharth Kesharwani, Omer Farooq
Embry Riddle Aeronautical University
2. INVESTIGATING THE EFFECTS OF ACUTE IMMERSION EXPOSURE TO THE ANTIDEPRESSANT VENLAFAXINE ON PHOTOTAXIS IN LARVAL DANIO RERIO
Abdullah Afridi, Christopher Souders, Christopher Martyniuk
University of Florida
3. FOOD FIGHTERS - A FOOD RECOVERY PROGRAM TO FIGHT HUNGER
Lauri Wright, Alice Sanchez
University of North Florida
4. WAKING UP FROM THE AMERICAN DREAM: EXAMINING ATTITUDES TOWARD ECONOMIC MOBILITY AMONG AMERICAN VOTERS
Alexander Adams, Douglas Ahler
Florida State University
5. THE LOCALIZATION OF NINEIN AND FORMATION OF NON-CENTROSOMAL MTOCS BY ZIKV
Aquesha Addison, Timothy Megraw
Florida State University
6. THERE IS SOMETHING IN THE WATER! CONTRIBUTION OF CHLORINATION BY-PRODUCTS IN THE WATER LEADING TO THE HEAD AND NECK CANCER PREVALENCE IN TAMPA BAY
Kimberly Dobrinski, Michele Crosby, Matthew Mifsud, Aaron Joseph, Siara Isabella
The University of Tampa
7. UNDERSTANDING THE RELATIONSHIP BETWEEN GOAL STRIVINGS, FEEDBACK ENVIRONMENT, AND FEEDBACK ORIENTATION
Alara Arpaci, Kelly Hall
Stetson University
8. AFRICAN SPINY MOUSE (ACOMYS) REGENERATION FOLLOWING ACUTE, CHRONIC, AND VOLUMETRIC MUSCLE LOSS INJURIES
Aaron Gabriel W. Sandoval, Jason O. Brant, Malcolm Maden
University of Florida
9. AORTIC VALVE LEAFLET CURVATURE AS A FUNCTION OF ELASTIN DEGRADATION
Amanda Barreto, Asad Mirza, Ahmed Ali, Sharan Ramaswamy
Florida International University
10. RESVERATROL AND ITS ANALOGS INHIBIT TRIPLE-NEGATIVE BREAST CANCER MOTILITY BY REGULATION OF EPITHELIAL-MESENCHYMAL TRANSITION
Megan Keller, Analiese Thomas-Larocque, Rachel Ranschau
Florida Gulf Coast University
11. **LOYALTY TO THE KING: THE CIRCUITS, INTERPRETATION OF THE OVERHAULED , POLICE-CREATED EXIGENCY DOCTRINE**
Alexander Cuneo
Florida International University
12. HOW FACEBOOK USAGE AFFECTS MENTAL HEALTH OF COLLEGE STUDENTS: RUMINATION GROUP RESULTS
Adam Barrett-Clarke, Hannah Buzbee, Gina Marie Weis, Michael Stasio, Erin Koterba, Erica Yuen
The University of Tampa
13. ADHERENCE TO WCRF/AICR CANCER PREVENTION RECOMMENDATIONS AND ITS IMPACT ON CANCER INCIDENCE, RECURRENCE, AND MORTALITY
Angelina Figueroa, Nadia Durham, Eunkyung Lee
University of Central Florida

Poster Session I

14. IT TAKES A VILLAGE TO RAISE WATER QUALITY: THE EFFECTS OF SELF-TAXATION MECHANISMS ON LAKE WATER QUALITY IN ORANGE COUNTY, FL
Andrew Hutchens, David Scrogin
University of Central Florida
15. COLLABORATIVE BIM: AN INNOVATIVE FRAMEWORK FOR LEARNING ARCHITECTURAL STRUCTURES
Aldrin James Gaffud, Nawari Nawari
University of Florida
16. THE RELATIONSHIP BETWEEN A FAMILY'S ECONOMIC STATUS AND THEIR CHILD'S ACADEMIC ACHIEVEMENT
Amanda Prozeralik, Jaylene Sosa, Skyler Pittman, Leigh Treadway, Sara Luepschen
Florida State University
17. SYNTHESIS AND COMPUTATIONAL STUDIES OF PEPTIDOMIMETICS AS POTENTIAL ANTICANCER AGENTS
Aaron J. Todman, Reed W. Roberts, Lucas S. Kline, Ralph N. Salvatore
Southeastern University
18. VIABILITY LOSS DURING THERMOINHIBITION STRESS IN DIFFERENT MASS *RUDBECKIA MOLLIS* (ASTERACEAE) SEEDS
Alec Chin-Quee, Nicholas Genna, Hector Perez
University of Florida
19. POLITICAL DIVIDE AND ITS INFLUENCE ON CIVIC ENGAGEMENT
Anthony Vultaggio, Alejandra Rodriguez
Florida Atlantic University
20. REDUCTION OF VOLUMETRIC SHRINKAGE IN STRUCTURES FABRICATED WITH MULTIPHOTON LITHOGRAPHY
Alexander Cockerham, Stephen Kuebler
University of Central Florida
21. EPISTEMIC INJUSTICE AND CREDIBILITY DEFICIT OF WOMEN IN MEDICINE
Destani Pennington
University of North Florida
22. COMPARATIVE ANALYSIS AND IDENTIFICATION OF CLASS 1 CRISPR-CAS GENES OF RECREATIONAL WATER STAPHYLOCOCCUS AUREUS
Brandon Lopez-Duenas, Rajesh Melaram
Eastern Florida State College
23. SUSCEPTIBILITY OF GL26 AND GL261 CELLS TO INFECTION BY THEILER, **MURINE** ENCEPHALOMYELITIS VIRUS
Devon Grey, Eric C. Freundt
The University of Tampa
24. THE STUDY OF SUPER FOODS FOR MARS EXPLORATION
Deanna DeMattio, Rafael Rodriguez, Hannah Skeen
Embry Riddle Aeronautical University
25. EFFECTS OF SOCIAL AND ACADEMIC ENGAGEMENT ON EPISODIC MEMORY IN YOUNG ADULTS
Kassandra Ramsdell, Sara Festini
The University of Tampa
26. BEYOND STEREOTYPES AND TYPECASTING; AN EXAMINATION OF TV REPRESENTATIONS OF AFRICAN AMERICAN FAMILY LIFE
Monique M. Satterfield
Bethune-Cookman University
27. SMOKING CESSATION FOR PREGNANT WOMEN: A REVIEW OF BEST PRACTICES
Allison Barthel, Mary Martinasek
The University of Tampa
28. THE EFFECT OF ANTENATAL LACTATION EDUCATION FOR MOTHERS DELIVERING PREMATURE INFANTS AND THEIR SUPPORT PERSON ON TIME TO SECRETORY ACTIVATION
Darchelle Excellent, Leslie Parker
University of Florida
29. FAT AND SODIUM CONTENT OF THE DIET INFLUENCE GLUCOSE METABOLISM, FOOD INTAKE AND BODY WEIGHT IN MALE Wistar RATS
Tatyana Kimble, Alireza Jahan-Mihan
University of North Florida

Poster Session I

30. SUCCESS IN LEARNING DISABLED STUDENTS
Emily Abramson
Beacon College
31. GROWTH AND SURVIVAL RATE OF THE SEA SLUG
ELYSIA SUBORNATA FEEDING ON VARIOUS
SPECIES OF CAULERPA
Sara Casareto, Michael Middlebrooks
The University of Tampa
32. UNDERSTANDING FISHING PRACTICES IN CABEZA
DEL TORRO, DOMINICAN REPUBLIC
Jahza Klochko, Jeanette Misuraca, Gabriela
Villalobos, Julia Walton
University of Florida
33. A NOVEL DEVELOPMENTAL MECHANISM
PATTERNS LEGS IN TARDIGRADES
Mandy Cumming, Frank W. Smith
University of North Florida
34. EFFORTS TOWARD THE SYNTHESIS OF 3,4-
DIHYDROXYPHENYLACETALDEHYDE (DOPAL): A
POTENTIAL ENDOGENOUS NEUROTOXIN THAT
MAY PLAY A ROLE IN THE DEVELOPMENT OF
PARKINSON'S DISEASE
Darby Huber, Tori Scheffler, Nicholas Schofield,
Josue Deslauriers, Jacob R. Hobby, Terrence E.
Gavin, Ralph N. Salvatore
Southeastern University
35. PIKE KILLIFISH POPULATIONS IN FLORIDA
Sy TerAvest, Natalia Belifore
The University of Tampa
36. THE PEER-MENTORING PROGRAM THAT CHANGED
THE DYNAMICS OF GATEKEEPER COURSES AT BCU
Tristen Johnson, Danyell S. Wilson-Howard
Bethune-Cookman University
37. THE INTERACTION OF COMMUNITY-BASED
LEARNING EXPERIENCE INTENSITY AND SEX ON
EMPATHY
Christiana Lall, B. Lynn McElyea, Keely
Lardizabal, Jody Nicholson
University of North Florida
38. A NOVEL STRATEGY FOR TARGETING HIV: TODAY
AND IN THE FUTURE
Richard Suarez, Janelle Nunez-Castilla, Jessica
Liberles
Florida International University
39. USING MUNG BEAN NUCLEASE AND BAL 31
NUCLEASE TO PROBE THE BINDING OF N-
METHYLPYRIDYLPORPHINES TO PHIX174 DNA
Edilmary Urdaneta, Stephen Winkle
Florida International University
40. THE EFFECT OF FAT AND SODIUM CONTENTS OF
THE DIET ON FOOD INTAKE, BODY WEIGHT, AND
BODY COMPOSITION IN MALE WISTAR RATS
Kea Schwarz, Alireza Jahan-Mihan
University of North Florida
41. EXAMINING FORENSIC EXPOSURE AND FORENSIC
KNOWLEDGE
Giovanna M. Alves, Daniel S. McConnell, Peter
A. Hancock
University of Central Florida
42. THE EFFECTS OF MUSIC TIMING ON AEROBIC
EXERCISE EXPERIENCE
Stephanie Escobar, Cristina Hernandez
Florida International University
43. EFFECTS OF GLOBAL CLIMATE CHANGE ON
BUILDING ENERGY CONSUMPTION AND
ADAPTATION MEASURES IN FLORIDA
Anna Kolodziejski, Aiyin Jiang
University of North Florida
44. RE-READING THE BELL JAR THROUGH DIGITAL
HUMANITIES: GRAPHICAL LINGUISTIC ANALYSIS
AND NEW FEMINIST READINGS
Isabella Hardesty
University of Central Florida
45. ENHANCED RESOURCE RECOVERY FROM
SECONDARY WASTEWATER BY INTEGRATING
ALGAE IN A SUBMERGED FORWARD OSMOSIS
SYSTEM
Sara Eghtessadi, Shiqiang Zou, Zhen He
University of Florida

Poster Session I

46. "ALL GRADES OF LIFE:" THE ISSUE OF CLASS IN AMERICAN COOKERY
Kennedy Harkins
University of Central Florida
47. THEODORE ABEL AS A POLITICAL THEORIST: NAZI WITNESSES AND THE EXCLUSION OF WOMEN
Sarah Warren, Daniel Maier-Katkin, Nathan Stoltzfus
Florida State University
48. A COMPARISON OF THE COAGULATION OF MICROALGA (GYMNODINIUM) BETWEEN CHITOSAN AND ALUM AND EFFECTS ON MACROALGAL (CHLOROPHYTA) SURVIVAL
Hannah Olson
Eastern Florida State College
49. A COMPARISON OF PHYSICAL ACTIVITY OF DUVAL COUNTY HIGH SCHOOL STUDENTS TO NATIONAL ACCORDING TO THE 2017 YRBS
Allie M Henderson, Abby Lorden, Montana Sloan
University of North Florida
50. AN EXPLORATION INTO THE PSYCHOTIC SYMPTOMS ASSOCIATED WITH SCHIZOPHRENIA AND MAJOR DEPRESSIVE DISORDER
Kyndester Michael-Samaroo
University of Central Florida
51. GRAPHIC AND ALGEBRAIC APPROACHES FOR R0 CALCULATION
Brian Chau
University of Central Florida
52. A META-ANALYSIS OF NEUROMYELITIS OPTICA EPIDEMIOLOGY IN LATIN AMERICAN NATIONS
Brittany M. Zengotita, Mohtashem Samsam
University of Central Florida
53. ONTOGENETIC SHIFTS IN VENOM COMPOSITION OF TWO RATTLESNAKE SPECIES (CROTALUS HORRIDUS AND CROTALUS ADAMANTEUS)
Emma Huff, Brandon Schonour, Schyler Ellsworth, Darin Rokyta, Matthew Holding
Florida State University
54. IMPACT OF STUTTERING ON COMMUNICATION ATTITUDE AMONG ADULTS WHO STUTTER AND THEIR LIFE PARTNER
Randy Panzarino, Martine Vanryckeghem
University of Central Florida
55. PREVALENCE OF INTESTINAL PARASITES IN RURAL LOCALITIES FROM PAMPA DEL INDIO, CHACO (ARGENTINA) AND RELATED RISK FACTORS
Lindsay Richards, Cintia Delgado, Marcia Goy, Victoria Periago
University of Florida
56. A STUDY OF THE INTERNAL MENTAL REPRESENTATION HEALTHCARE PROFESSIONALS HAVE TOWARDS ADDICTION
Tyla Gelman, Curtis Phills
University of North Florida
57. INCREASING COGNITIVE CONTROL AND REDUCING RACIAL BIAS THROUGH ANTI-STEREOTYPE TRAINING
Kristan N. Palermo, Katherine C. Hooper, Jennifer M. Wolff, Tyla Gelman, Curtis E. Phills
University of North Florida
58. EFFECTS OF SUPERBLOOM CONDITIONS ON ZOOPLANKTON DENSITY IN THE INDIAN RIVER LAGOON, FL
Jonathan Johnson, Sarah Krejc
Bethune-Cookman University
59. UNDERSTANDING THE EFFECTS OF CLIMATE CHANGE ON AMERICAN ALLIGATOR SEX RATIOS
Molly O'Brien, Adam Rosenblatt
University of North Florida
60. DATA FUSION FOR A VISION-AIDED RADIOLOGICAL DETECTION SYSTEM - SODIUM IODIDE DETECTORS VERSUS LIQUID SCINTILLATOR DETECTORS
Kelsey Stadnikia, Kristofer Henderson, Sanjeev Koopal, Andreas Enqvist
University of Florida

Poster Session I

61. REPRODUCTIVE SUCCESS OF MALE SYNGNATHUS SCOVELLI PIPEFISH ACROSS SEASONS
Magaleate Kostelnik, Julia Skowronski, Heather Masonjones, Emily Rose
The University of Tampa
62. ZORA NEALE HURSTON, TOVE JANSSON AND THE MODERNISMS OF GLOBAL WOMEN
Farrah Kurronen
University of Central Florida
63. CONSTRUCTION OF A TREATMENT WETLAND TO REDUCE NUTRIENT LOADING FROM STORMWATER RUNOFF INTO COASTAL WATERS
Miranda White, Abraham Disilvio, Hyun J. Cho
Bethune-Cookman University
64. THE GENETICS OF ALZHEIMER'S DISEASE
Annaleigh Nowell
Troy University
65. SHIFTING THE PARADIGM OF DEPRESSION BY STUDYING KETAMINE
Miguel Duran
Troy University
66. COLOR THEORY
Briana Borders
Troy University
67. FLORIDA RED TIDE AND THE ORGANISMS THAT ARE ABLE TO SUSTAIN LIFE IN SUCH CONDITIONS: CASSIOPEIA SP. AND BURSATELLA LEACHII
Alexandra Sullivan
The University of Tampa
68. THE GENDER FACTOR: HOW MALE AND FEMALE SEXUAL OFFENDERS ARE PERCEIVED AND PROCESSED DIFFERENTLY IN AMERICAN SOCIETY
Julia-Beth Brown
University of Central Florida
69. EXAMINING THE IMPACT OF FAMILY ON JUVENILE MENTAL HEALTH AND RECIDIVISM DURING REENTRY
Nicole Palmeri, Jill Viglione
University of Central Florida
70. THE EFFECT OF ALTERNATE SUPPLEMENTARY CEMENTITIOUS SOLUTIONS ON PORE WATER AND REBAR PASSIVATION
Christopher Ferraro, Caitlin Tibbetts, Alexander Campano
University of Florida
71. UBIQUITIN-BINDING OF NASCENT POLYPEPTIDE-ASSOCIATED COMPLEX (NAC) PROTEIN IN ARCHAEA
Ling Jin, Zachary Adams, Christopher Batbatan, Julie A. Maupin-Furlow
University of Florida
72. DANTE'S POEM PROVIDING A COMMON LANGUAGE FOR THE GENRE OF SURREAL HORROR
Alexa Kellenberger
Florida State University
73. LONG TERM 3D CELL CULTURE IN PERFUSIVE FLOW
Kylie E. Van Meter, Derek L. Hood, Juan M. Uruena, Padraic P. Levings, Colin Anderson, Eric O. McGhee, Greg Sawyer
University of Florida
74. GRATING COUPLER FOR SURFACE WAVES BASED ON ELECTRIC DISPLACEMENT CURRENTS
Jonathan Brescia
University of Central Florida
75. ROLE OF INTERLEUKIN-10 SIGNALING IN A MOUSE MODEL OF ALPHA SYNUCLEINOPATHY
Samuel Cockey, Emily Koller, Mieu Brooks, Todd E. Golde, Benoit Giasson, Paramita Chakrabarty
University of Florida
76. PROTEIN DISULFIDE ISOMERASE DISRUPTS AND DETOXIFIES AGGREGATES OF AMYLOID BETA PEPTIDE
Haley Lehew, Baggio Evangelista, Lucia Cilenti, Ken Teter
University of Central Florida

Poster Session I

77. PRELIMINARY OBSERVATIONS ON THE UPTAKE OF MICROPLASTICS IN THE ATLANTIC SHARPNOSE SHARK (RHIZOPRIONODON TERRAENOVAE) AND THE ATLANTIC STINGRAY (HYPANUS SABINA) ON THE SOUTHEAST U.S. COAST
Cailla Strobel, Sarah Noonan, Jim Gelsleichter
University of North Florida
78. DETERMINING PERCEPTION OF MEDIA BIAS
Grace Sauter, Daniel Terry
Florida Atlantic University
79. DETERMINING SPATIAL AND TEMPORAL WATER QUALITY CHANGES IN THE HALIFAX RIVER LAGOON (HRL), FL
Jehmia Williams, Juan Calderon, Sarah Krejci
Bethune-Cookman University
80. FEEDING SELECTIVITY OF JUVENILE SEAHORSES ON WILD ZOOPLANKTON DURING EARLY DEVELOPMENT
Alyssa Stubbs, Vikash Bisram, and Sarah Krejci
Bethune-Cookman University
81. SLOTTED TRANSMISSION LINE FOR WAVELENGTH MEASUREMENTS
Gerald Onesky, Chiu Choi
University of North Florida
82. THE WRIGHT BUILDING RECOGNITION PROJECT
Chelsea Seaver, Asal Johnson
Stetson University
83. FISHING FOR ATTENTION, BUT NOT CATCHING ANYTHING? ADVERTISING TO MILLENNIALS IN A DIGITAL OCEAN OF CONTENT
Augustinas Navickas
Bethune-Cookman University
84. HOMARUS AMERICANUS KIDNEY 3D CELL CULTURE
Kenneth Davis, Melinda Moffitt, Fatima Rehman, Gregory Ahearn
Edward Waters College; University of North Florida
85. IDENTITY AND GUILT: AN INVESTIGATION OF PRO-ENVIRONMENTAL SPILLOVER
Monica Fagundo, Alexa Stauffer, Heather Truelove
University of North Florida
86. WAR TIME CORRESPONDENCE: HOW INTERPERSONAL COMMUNICATION FUNCTIONED DURING WORLD WAR I AND WORLD WAR II
Veronica Carver, Michael Neal
Florida State University
87. BEYOND THE FORCE: FINDING IDENTITY IN STAR WARS COSTUMING
Kaley Crawford
University of North Florida
88. A COMPARISON OF IN VITRO ASSEMBLY OF HIV AND SIV
Arianna Broad, Robert Dick, Volker Vogt
Florida State University
89. BODY SIZE SATISFACTION IN MALE AND FEMALE AFRICAN AMERICAN ADOLESCENTS
Frances Breanna McDonald, Tatyanna Aviles-Wilcher, Sam Ronderos, Dawn Witherspoon
University of North Florida
90. SMART WALKER FOR THE VISUALLY IMPAIRED
Christopher Feltner, Jonathan Guilbe, Sharare Zethabian, Siavash Khodadadeh, Lotzi Boloni, Damla Turgut
University of Central Florida
91. EXPLORING INSULIN-LIKE GROWTH FACTOR (IGF-1) REGULATION OF CRITICAL LIFE HISTORY EVENTS IN WEDDELL SEALS (LEPTONYCHOTES WEDDELLII)
Hanna Malik, Amy Kirkham, Jennifer Burns, Julie Avery
University of North Florida

92. LANGUAGE PROCESSING AND LATERALITY
AMONG BILINGUALS: EVENT-RELATED POTENTIALS
AND BEHAVIOR

Salim Mouloua, Stephanie Castelin & Mustapha
Mouloua

University of Central Florida

93. ROLE OF HIPPOCAMPAL CA1 DOPAMINE
RECEPTOR SIGNALING IN
NOVELTY DISCRIMINATION

Meena Ravi, Sarah A. Johnson, Sara N. Burke

University of Florida

94. ELUCIDATING THE SURVIVAL OF INTRACELLULAR
SALMONELLA ENTERICA SEROVAR TYPHIMURIUM
MUTANTS IN EFFORT TO IDENTIFY THE
IMMUNOLOGICAL CHARACTERISTICS OF
EXTRACELLULAR VESICLES ON NAIVE
MACROPHAGES

Charlene Mitchell, Winnie Hui, Mark Ou, Mariola
Edelmann

University of Florida

Poster Session II

1. ROLE OF HIPPOCAMPAL CA1 DOPAMINE RECEPTOR SIGNALING IN NOVELTY DISCRIMINATION
Meena Ravi, Sarah A. Johnson, Sara N. Burke
University of Florida
2. THE EFFECT OF MUSIC ON PAIN OBSERVATION
Amy LiKamWa, Roger Fillingim, Jill Sonke, Staja Booker, Josue Cardoso
University of Florida
3. THE AILMENTS OF ARCHIVISTS: HOW KORESHAN IMPACT IS A DOUBLE-EDGED SWORD
Kayleigh Heister
Florida Gulf Coast University
4. "THE SHOCK HEARD AROUND THE WORLD": A COMPARATIVE STUDY OF MEDICAL AND LITERARY REPRESENTATIONS OF SHELL SHOCK, 1914-50
Madison Das
University of Central Florida
5. CARBON SUPPORTED NOBLE-METAL NANOPARTICLES FOR THE CATALYTIC REDUCTION OF NITROPHENOLS AND AZO DYES
Lorianne R. Shultz, Xiaofeng Feng, Titel Jurca
University of Central Florida
6. HOW DO BLOGS FACILITATE THE PROMOTION OF HEALTH NARRATIVES IN PEOPLE WITH SYSTEMIC LUPUS ERYTHEMATOSUS, AND WHY ARE "SUCCESS STORIES" NOT THE ULTIMATE GOAL?
Abageal Roland
Florida Atlantic University
7. COMPARATIVE EXPRESSION OF GD2 AND GD3 AS TRANSLATIONAL OSTEOSARCOMA IMMUNOTHERAPY TARGETS
Zachary Emmanuel Sandoval, Matthew Cascio, Marc Salute, Bikash Sahay, Galaxia Cortes-Hinojosa, Rowan Milner
University of Florida
8. SUPERFUND SITES BY BLACK POPULATION - HILLSBOROUGH COUNTY, FLORIDA
Julia Jester, Casey Butterfield
University of Tampa
9. LONELINESS AND ITS EFFECTS ON INTERPRETATION AND ATTRIBUTION OF MEANING IN EMOJIS
Dishanki Savla, Kendahl Krause, Tara Owens, Daniel S. McConnell, Janan A. Smither
University of Central Florida
10. COMBATING CHALLENGES IN CYBER SECURITY EDUCATION
Arati Banerjee, Salih Safa Bacanli, Cliff Zou, Damla Turgut
University of Central Florida
11. HOW DOES ONLINE LANGUAGE TEACHING COMPARE TO A TRADITIONAL CLASSROOM?
Andrew DeMil, Rachel Kozikowski
The University of Tampa
12. A COMPARISON OF PHOTOTAXIC BEHAVIOR IN PHOTOSYNTHETIC AND NON-PHOTOSYNTHETIC SACOGLOSSAN SEA SLUGS
Lauren Twele, Rachel Moline, Michael Middlebrooks
The University of Tampa
13. IN-VITRO TOXICITY OF CHEMICAL AND BIOLOGICAL NANOPARTICLES ON NORMAL HUMAN DERMAL FIBROBLASTS
Samantha Courtney, Pavan Rajanahalli, Sneha Krishnamurthy
The University of Tampa

Poster Session II

14. EVALUATION AND OPTIMIZATION OF FLOATING AQUATIC TREATMENT WETLANDS FOR PHYTOREMEDIATION PRE-TREATMENT OF MUNICIPAL LANDFILL LEACHATE EMPLOYING SALINE-TOLERANT PLANTS NATURAL TO SOUTH FLORIDA
Ashley Danley-Thomson, Cassandra Bayes, Morgan Humphrey, Sarah Stauring, Sandra Un Jan Contreras
Florida Gulf Coast University
15. RESILIENT INFRASTRUCTURE AND CARGO ELASTICITY FOLLOWING A NATURAL DISASTER
Emily Jannace, Scott Parr
Embry Riddle Aeronautical University
16. GEOGRAPHIC EFFECTS ON THE VIEWS OF CLIMATE CHANGE AND GLOBAL WARMING
Jarron Koretz, Austin Silverstein, Monica Escaleres
Florida Atlantic University
17. UNPLEASANT IMAGES CAUSE NEURAL INHIBITION IN THE PREFRONTAL CORTEX
Vernon Volante, Sara Fagen, Carly Doyon, Jesse Macyszko, Katherine Hooper
University of North Florida
18. FORCE TRENDS DURING NON-INVASIVE KNEE INJURY OF THE MURINE ANTERIOR CRUCIATE LIGAMENT
Jessica Hornyak, Shannon Brown, Blanka Sharma
University of Florida
19. REIMAGINING DRUGS: AN ANTHROPOLOGICAL ANALYSIS OF U.S. DRUG POLICY FRAMEWORKS AND STUDENT ACTIVISM
Megan Sarmiento
University of Central Florida
20. WHEN PARTICIPANTS MESS UP YOUR DATA: CONSEQUENCES AND CONTROLS
Kendahl Krause, Victoria Pineda, Wyatt Kinner, Tara Owens, Fernando Montalvo, Daniel S. McConnell, and Janan A. Smither
University of Central Florida
21. THE ROLE OF LGBTQ+ SPECIFIC ORGANIZATIONS IN COMMUNITIES
Rebecca Weiner
University of North Florida
22. "DRUG DEALERS, CRIMINALS AND R*PISTS:" HOW MEDIA REPRESENTATIONS OF IMMIGRANTS JUSTIFIES THEIR DETAINMENT
Savanha Renald
University of Florida
23. VOLATILITY SHOCKS? ANOTHER LOOK AT OIL PRICE PASS-THROUGH
Kyle Cohen
University of North Florida
24. ANALYSIS OF POTENTIAL RECREATIONAL WATER CONTAMINATION WITH FECAL INDICATOR BACTERIA AT LYNN UNIVERSITY
Esther Ushuhuda, Eric Merkel, Cassandra S. Korte
Lynn University
25. WHAT IS THE PUBLIC PERCEPTION OF WELFARE IN AMERICA?
Alyssa Alvarez, Nikole Holness
Florida Atlantic University
26. EXAMINING THE RELATIONSHIP BETWEEN INNOVATIVE PAYMENT MODELS AND HOSPITAL READMISSION RATES
Meghan Hufstader Gabriel, Danielle Atkins, Ajit Appari, Michael Maresca, Kendall Cortelyou-Ward, Timothy Rotarius, Vincent Pereira
University of Central Florida

Poster Session II

27. RECOGNIZING THE BOILING OF LIQUIDS USING CONVOLUTIONAL NEURAL NETWORKS
Mary Rasura, William Hahn
Florida Atlantic University
28. ENGINEERING OF NOVEL MATRIPTASE INHIBITORS BASED ON EGLIN C CORE STRUCTURE
Dalia Soueid, Lauren Schmidt, Maciej J. Stawikowski
Florida Atlantic University
29. STRESS RELIEF: POST-DISASTER VOLUNTEERING IN FLORIDA AND TEXAS PARKS/GARDENS
Grace Robbins
Florida State University
30. STUDENTS' PERCEPTIONS OF THE ACADEMIC EFFECTS OF SLEEP DISTURBANCES IN A COMMUNITY COLLEGE SETTING: A QUALITATIVE APPROACH
Jose Martinez, Gisela Diaz
Florida State University
31. THE VALUE OF A VOTE: HOW CIVIC ENTHUSIASM INFLUENCES VOTING HABITS
Geoffrey Leavitt and Crayton Hudspeth
Florida Atlantic University
32. EFFICACY OF ASYMMETRIC WAVEFORMS AND THE ROLE OF PHASE DELAY FOR SOMATOSENSORY CORTEX MICROSTIMULATION: A PARAMETERIZATION STUDY
Nicolas Kunigk, Morgan E. Urdaneta, Kevin J. Otto
University of Florida
33. CLARIFYING THE IMPACT OF PSYCHOPATHY ON DILEMMA JUDGMENTS VIA PROCESS DISSOCIATION: THE ROLE OF MEANNESS, BOLDNESS, AND DISINHIBITION
Francklen Celestin, Caleb Reynolds, Paul Conway
Florida State University
34. DESPERATE TIMES CALL FOR DESPERATE MEASURES: HOW BORDER FORTIFICATION INTENSIFIES TRANSNATIONAL INSURGENTS' VIOLENCE AGAINST CIVILIANS
Jeffrey Coltman-Cormier
Florida Atlantic University
35. EVALUATION OF 2017 YRBS DATA ON SEXUAL BEHAVIORS AMONG MALE AND FEMALE HIGH SCHOOL STUDENTS
Jane Stanhope, Kara Rodgers
University of North Florida
36. LONG-TERM DIFFERENCES IN PUBESCENT FEMALE OUTCOMES AFTER MODERATE TO SEVERE TBI
Emily Wing, Hailey Schwab, Maria Kerrigan, Jennifer Munoz-Pareja
University of Florida
37. ARTIFICIAL INTELLIGENCE FOR BCI AND EEG FEATURE DETECTION
Harrison Rudd, Talia McNulty, Jacob McNulty, Alex Clark, Anthony Sanchez, Taslim Bhuiya, Elan Barenholdz
Florida Atlantic University
38. INVESTIGATING THE RELATIONSHIP BETWEEN HEAD SHAPE AND ELEVATION IN BLACK TAILED RATTLE SNAKES
Sarah Sullivan, Matthew Holding, Timothy Coltson, Darin Rokyta
Florida State University
39. ELECTRICAL STIMULATION OF HUMAN DERMAL FIBROBLASTS FOR WOUND HEALING
Stephanie Schreiner Macassi, Ashley Santana, Alicia Willenberg, Melanie Coathup, Kaitlyn Crawford
University of Central Florida
40. BINDING TO SIGMA RECEPTOR 1 FOR IDENTIFICATION OF POTENTIAL TREATMENTS FOR CHRONIC PAIN
Jasmine Cano, Talia Kawesa, Heba Agha, Sebastiano Intagliata, Christopher McCurdy, Lawrence Toll
Florida Atlantic University

Poster Session II

41. THE EFFECTS OF INFRASTRUCTURE SERVICE DISRUPTIONS AND SOCIO-DEMOGRAPHIC FACTORS ON HOUSEHOLDS: HURRICANE RECOVERY
Sydney Elney
Florida Atlantic University
42. EXAMINING THE RELATIONSHIP BETWEEN DIETARY BEHAVIOR AND PSYCHOLOGICAL WELL-BEING
Diamond Blair, Hartly Hutchings, Ted Cascio
Palm Beach State College
43. RECOGNIZING SCRABBLE LETTERS USING A NEURAL NETWORK
Alexander Faus, Matthew Eicholtz
Florida Southern College
44. GENDER AND THE AFFORDABLE CARE ACT
Aniela Edwards and Mackenzie Manofsky
Florida Atlantic University
45. NICOTINE AND SILDENAFIL AS A MODEL FOR PESTICIDE RESISTANCE IN AGRICULTURE
Raymond MacKoul and Kimberly Rowland
Lynn University
46. EFFECTS OF RESISTANCE AND AEROBIC TRAINING ON GROWTH FACTOR EXPRESSION AND BETA AMYLOID IN A MURINE MODEL OF ALZHEIMER'S DISEASE
Michael Correa, Gabriel S. Pena, Hector G. Paez, Trevor K. Johnson, Joseph P. Carzoli, Jessica L. Halle, Nishant P. Visavadiya, Michael C. Zourdos, Andy V. Khamoui, Michael A. Whitehurst
Florida Atlantic University
47. ESTAS READY?: UNCOVERING AFRO-LATINX IDENTITIES THROUGH LANGUAGE
Elisabeth Rios-Brooks
University of Florida
48. MEASURING THE NUTRITION KNOWLEDGE OF NCAA DIVISION II ATHLETES
Laura VanderStarre, Sara Terrell
Florida Southern College
49. THE IMPACT OF MICROPLASTICS ON CRASSOSTREA VIRGINICA FILTRATION EFFICIENCY
Jenna Carpenter, Brianna Sierra
University of Tampa
50. IOT WEATHER STATION CLOUD AND SYSTEM CONFIGURATIONS
Robert Corso, David Lau, Matthew Longmire, Robert Connor, Emilio Vazquez, Tomas Helou, Yu Liu, Rony Schutz, Zhengxiang Feng, William Eisenstadt
University of Florida
51. THE DIGITAL KILLER OF PRINT MEDIA: INVESTIGATING COLLEGE STUDENTS' NEWS CONSUMPTION HABITS
Mariyah Espinoza
Bethune-Cookman University
52. PROMOTING A DUTY TO ADOPT
Anne Merrill, Laura Kane
University of Tampa
53. RACE PORTRAYALS FOR MURDER
Brianna Dale, Chastity Blankenship
Florida Southern College
54. THE DORSET CHRONOTOPE: AN ECOCRITICAL READING OF THOMAS HARDY'S "JUDE THE OBSCURE" AND "THE MAYOR OF CASTERBRIDGE"
David Advent, Barry Faulk
Florida State University
55. WHALE SHARK (RHINCODON TYPUS) RETINAL PIGMENTS AND VISUAL FORAGING ECOLOGY
Katherine Serba, Jeffry Fasick, Haya Algrain, Phyllis Robinson
The University of Tampa
56. THREE TIER BINARY SPIN LATTICE
Fred Browning, Emily Bishop
Palm Beach Atlantic University
57. WOMEN, CONFIDENCE, AND POLITICS
Mary Anderson, Haley Hill, Alexis Laroe, Courtney Wilson
The University of Tampa

Poster Session II

58. USING THE KETOGENIC DIET AS AN ADJUVANT TO CANCER THERAPY: A SYSTEMATIC REVIEW
Melanie Risola, Christopher Cacciatore, Humberto Lopez Castillo, Eunkyung Lee
University of Central Florida
59. WHAT'S MORE AMERICAN THAN A VIOLA? NATIONALISM IN DVORAK'S "STRING QUINTET IN EB"
Emily Dunn
Florida Gulf Coast University
60. DISADVANTAGES OF DISCLOSURE: THE IMPACT OF SEXUAL ORIENTATION ON HIRING DECISIONS
Kenzie Hurley, Hannah Smith, Charlie Law
Florida Southern College
61. PROTEIN-POLYMER BIOCONJUGATION EFFECTS ON ACTIVITY AND STABILITY OF CELLULASE (FNCEL5A) WITH VARYING MOLECULAR WEIGHTS OF POLYMER CHAINS
Natasha Ram, Thaiesha Wright
University of South Florida
62. OZONE SOURCE FOR COMPLEX OXIDE GROWTH USING MOLECULAR BEAM EPITAXY
Dakota Brown, Maitri Warusawithana, Conor Kelly, Robert Dawson, Caitlin Kengel
University of North Florida
63. FORWARD OSMOSIS FLOW RATE DIFFERENTIAL
John Trzinski, Eric Seedhouse
Embry Riddle Aeronautical University
64. CHARACTERIZING HUMAN TARGET CELL INFECTION BY THREE GEOGRAPHICALLY DISTINCT ISOLATES OF MAYARO VIRUS
Aum Patel, Jordan Dailey, Melissa Dulcey, Ruiyu Pu, Amy Vittor
University of Florida
65. NEURAL ACTIVITY, GENES, AND MENTAL HEALTH
Austin Gallyer, Katie Sinsko, Jalisia Goodman
Florida State University
66. A NONDESTRUCTIVE METHOD FOR MONITORING ANTHOCYANIN ACCUMULATION IN ARABIDOPSIS
Bryce Askey, Jeongim Kim, Ru Dai, Won Suk Lee
University of Florida
67. THE ROLE OF COGNITIVE BIASES IN THE MORAL PERMISSIBILITY OF NUDGES
Valerie Joly Chock
University of North Florida
68. SAFE SPACES FOR BLACK STUDENTS AT PWIS
Simone Yuille, Vincent Adejumo
University of Florida
69. CROSS-MODAL DISTRACTION ON SIMULTANEOUS TRANSLATION: LANGUAGE INTERFERENCE IN SPANISH-ENGLISH BILINGUALS
Violet Young, Doan Modianos
University of Central Florida
70. CAN A PILL MAKE YOU SMARTER? COGNITIVE ENHANCEMENT AMONG COLLEGE PRE-HEALTH STUDENTS FOR ACADEMIC GAIN
Zoreed Mukhtar
University of Central Florida
71. INCORPORATING FLIPPABLE MOMENTS IN A COLLEGE BIOCHEMISTRY COURSE: ASSESSMENT OF STUDENT PERFORMANCE AND STUDENT ATTITUDES
Alaa Hashim, Zoreed Mukhtar
University of Central Florida
72. FISHING FOR DISORDER: UNCOVERING DISORDERED PROTEINS AMONG COPY NUMBER VARIANTS IN DANIO RERIO
Anthony Brando, Kimberly Dobrinski
The University of Tampa
73. EFFECTS OF A THREE STAGE POST-PERFORMANCE ROUTINE ON PUTTING PERFORMANCE
Payton Howarth, Jason Kostrna, Brian Foster, Jean-Charles Lebeau, Gershon Tenenbaum
Florida State University

Poster Session II

74. PROJECT NAUTILUS: LOWERING THE COST OF OCEANIC RESEARCH
Devon Vail, Sayan Chatterjee, Ernest Kohnke
Embry Riddle Aeronautical University
75. BIOMIMETIC SYNTHESIS OF BRIARANE DITERPENOIDS FROM BRIAREIUM ASBESTINUM
Shakia Williams, Paul Scesa, Lyndon M. West
Florida Atlantic University
76. INJECTOR FLOW MODEL OF A PIEZOELECTRIC DIESEL INJECTOR
Josh Didion, John Nuskowski
University of North Florida
77. STUDENT LEARNING ASSISTANTS IN LARGE-ENROLLMENT COURSES: THE FSU EXPERIENCE
Kayleigh Weintraub, Sarah Engel, Fabrizio Fornara
Florida State University
78. THE COLLECTION AND ANALYSIS OF DNA BEFORE AND AFTER THE USE OF FINGERPRINT POWDER ON DIFFERENT SURFACES
Berthie Lebrun, Courtney Rush, Nicolyn Skyers, Sulekha Coticone
Florida Gulf Coast University
79. PROCESSING AND MECHANICAL PROPERTIES OF ZRO₂-BASED ELECTROLYTES CERAMICS FOR SOLID OXIDE FUEL CELLS
Zoe Barbeau, Arturo Coronado, Nina Orlovskaya
University of Central Florida
80. SURFACE MODIFICATION OF THE SP² NETWORK OF CARBONACEOUS NANOMATERIALS
Mounisha Ganesan, Virginie Rollin, Daewon Kim, Foram Madiyar
Embry Riddle Aeronautical University
81. INVESTIGATING MELATONIN LEVELS AND CIRCADIAN PERIODS AFFECTING THE BREAST CANCER RATES OF GHANAIAI WOMEN
Yanelis Diaz, Stephen Scheller, Mohtashem Samsam
University of Central Florida
82. STRUCTURAL AND EVOLUTIONARY ANALYSIS OF THE ACTIVATION MECHANISM IN THE SK CHANNEL-CALMODULIN COMPLEX
Brittany Montesino, Jessica Liberles
Florida International University
83. DATA MINING LITERATURE ANALYSIS OF CITED PDB STRUCTURES
Natalie Verdiguél, Zukang Feng, John Westbrook, Christine Zardecki, Stephen Burley
University of Central Florida
84. SELF-COMPASSION AMONG PARENTS AND NON-PARENTS
Emily Vernet, Melissa Birkett
University of Central Florida
85. ASSESSING EXCELLENCE UNIVERSITY EFFECTIVENESS
Anyoliny Sanchez, Martin Heesacker, Brian Higley
University of North Florida
86. STUDY ON TECHNOLOGY AND LEARNING
Jeremy Bramwell, Daniel McConnell
University of Central Florida
87. THE RELATIONSHIP BETWEEN SLEEP DEPRIVED COLLEGE STUDENTS AND INTERNALIZING SYMPTOMS CAUSED BY PERCEIVED ACADEMIC WORKLOAD
Manuel Merino
Florida International University
88. THE IMPORTANCE OF RACE AS AN ADVERSE CHILDHOOD EXPERIENCE
Serena Bradshaw, Karen Oehme, Ann Perko
Florida State University
89. SELF-ESTEEM AND RISKY BEHAVIORS IN COLLEGE STUDENTS
Victoria Riancho, Patrick Cooper, Robert Riedel
Lynn University

90. VACCINATION AS A TECHNIQUE TO INDUCE
ACQUIRED RESISTANCE TO BATRACHOCHYTRIUM
DENDROBATIDIS (BD)

Caitlin L. Nordheim, Sarah E. Detmering, Taegan
A. McMahon

The University of Tampa

91. ABUNDANCE ANALYSIS OF TABBY'S STAR (KIC-
8462852)

Stacey Thomas, Simon Schuler, Cintia Fernanda
Martinez, Katia Cunha, Verne Smihth

The University of Tampa

92. TISSUE SPECIFIC COMPENSATORY REGULATION
OF GENE EXPRESSION ASSOCIATED WITH COPY
NUMBER VARIANTS IN DANIO RERIO

Sherrea Brown, Kimberly Dobrinski

The University of Tampa

93. SPIRITUALITY'S ASSOCIATION WITH AGE, GENDER,
AND EXTRINSIC MOTIVATION: FINDINGS FROM
AN INTERNATIONAL SURVEY STUDY

Jessica Cothron

University of South Florida Sarasota

94. RESTRICTED BOLTZMANN MACHINES FOR
INVERTIBLE BOOLEAN LOGIC

Madison Manley, Saavan Patel, Sayeef
Salahuddin

University of Central Florida

Poster Session III

1. COLLEGE-AGED STUDENTS SENSORY PERCEPTION COMPARING SORGHUM TO RICE IN READY-MADE DISHES
Diannette Osorio, Marissa Schwam, Krystal Walker, Cynthia Whitmer, Juan Salcedo, Kristen Hicks-Roof
University of North Florida
2. USING FNIRS TO STUDY COLLEGE STUDENTS' READING STRATEGIES
Jesse Macyczko, Sabrina Greene, Daniel L. Dinsmore, Katherine C. Hooper
University of North Florida
3. ANTI-OXIDANT ENZYME ANALYSIS IN MUSCLE OF ATLANTIC SHARPNOSE SHARK
Maya Fisher, Louise Persson, Gretchen K. Bielmyer-Fraser
Jacksonville University
4. SYNTHESIS OF MESOPOROUS COPPER OXIDE ON NI OXIDE FOAMS
Hayden Hadley, Titel Jurca
University of Central Florida
5. MIRANDA FRICKER, ALISON WYLIE, AND THE PREVENTION OF TESTIMONIAL INJUSTICE
Daniel Riggins, Jonathan Matheson, Kyle Hodge
University of North Florida
6. PREDICTING SUBSTANCE USE DISORDER TREATMENT OUTCOMES WITH MACHINE LEARNING
Nicole Fitzgerald, Elan Barenholtz
Florida Atlantic University
7. DETECTION OF EXPLOSIVE MATERIALS USING GRAPHENE NANOPORES
John Dimuna, Jason Haraldsen
University of North Florida
8. BONOBO: THE FUNCTION OF SEXUAL SWELLING IN CAPTIVITY
Tylyn Dagsaan
University of North Florida
9. CORRECTION OF SPATIALIZATION ISSUES IN ACOUSMATIC MUSIC: REMEDYING INCOMPATIBILITY BETWEEN SPATGRIS AND LOGIC PRO X
John Levee
Stetson University
10. PORPHYROMONAS GINGIVALIS MEDIATED ENDOTHELIAL DYSFUNCTION BY EXOSOMES RELEASE IN HUMAN CORONARY ARTERY ENDOTHELIAL CELLS
Khadija Kamara, Heran Getachew, Anne Progulske-Fox
University of Florida
11. THERMODYNAMICS AND MAGNETIC EXCITATIONS IN QUANTUM SPIN TRIMERS: APPLICATIONS TO THE UNDERSTANDING OF MOLECULAR MAGNETS
Amelia Brumfield, Jason Haraldsen
University of North Florida
12. GENDERED TRANSITIONS: HOW TRANSGENDER AND NON-BINARY COLLEGE STUDENTS NAVIGATE DORM LIFE AND THE COLLEGE EXPERIENCE
Dalton Reynolds
University of North Florida
13. DIABETES-RELATED BENEFITS OF SOCIAL SUPPORT IN ADOLESCENTS WITH A MINORITY BACKGROUND BEING TREATED FOR TYPE 1 DIABETES
Sydney Johnson
Florida Southern College
14. ASSESSMENT OF MORINGA SEED COATED SAND FILTER AS A SECONDARY DRINKING WATER TREATMENT STEP FOLLOWING BIOSAND FILTRATION: A FIELD STUDY AT ECHO'S APPROPRIATE TECHNOLOGY VILLAGE
Ashley Danley-Thomson, Rene Mendoza Gonzalez, Austin Wise
Florida Gulf Coast University

Poster Session III

15. ADULT NEUROGENESIS IN A BRITTLE STAR IS DRIVEN BY A DISTINCT POPULATION OF RADIAL GLIAL CELLS
Lauren Whaley, Olga Zueva, Vladimir Mashanov
University of North Florida
16. EXPLORING THE NEURAL CORRELATES OF SELF-MONITORING WITH FNIRS
Ambriel Cohen, Paul Fuglestad, Katherine Hooper, Christopher Leone
University of North Florida
17. A QUANTITATIVE APPROACH TO ESTIMATING FISHING PRESSURE ON IMPORTANT RECREATIONAL FISHES WITHIN TAMPA BAY
Madison L. Dowdy, Bridgette F. Froeschke
The University of Tampa
18. THE DIFFERENCES IN GENDER IN COMPARISON TO SELF-ESTEEM AND BODY IMAGE
Sian-Marie Laws
Beacon College
19. FACING THE MUSIC: THE CURRENT STATE OF STREAMING SERVICES IN THE MUSIC INDUSTRY
Jessica Korver, Silviana Falcon
Florida Southern College
20. MERCURY CONCENTRATIONS IN THE OCEANIC WHITETIP SHARK, *CARCHARHINUS LONGIMANUS*, OFF OF CAT ISLAND, BAHAMAS
Graceann Sparkman, Oliver Shipley, Edward J. Brooks, Lucy Howey, Jim Gelsleichter
University of North Florida
21. METHANOL CLUSTERS FORMED VIA MASS SPECTROMETRY PLAY A ROLE IN SOLUBILITY
Rachel E. Mizrahi, Melanie C. White, Jennifer E. Ruliffson, Matthew Kourey, Joshua J. Melko
University of North Florida
22. CHERRY-PICKING AS EPISTEMIC INJUSTICE
Benjamin Beatson
University of North Florida
23. THE UNCOVERED ILLNESS IN CHARLOTTE TEMPLE: SOCIOPATHY AND SOCIETY
Abigail Nelson
The University of Tampa
24. EVALUATION OF ANTIOXIDANT CAPACITY OF FLORIDA NATIVE AND NON-NATIVE PLANTS
Taylor Reid, Ciara Dove, Sally Tran, Rosa Chavez, Andrea Arikawa
University of North Florida
25. SELECTIVE NON-CATALYTIC REDUCTION (SNCR): TWO-ZONE MODEL
Melissa Messenger, Steven Hillesheim, Davis Lovell, Michael Williams, John Nuszkowski
University of North Florida
26. AUTOMATED CELL STRETCHING DEVICE FOR MECHANOBIOLOGY EXPERIMENTS
Myra Kurosu Jalil, Justin Keister, Anthony Yin, Chelsey Simmons
University of Florida
27. MATHEMATICAL MODELING ANALYSIS OF LONGITUDINAL CONTROL AND STABILITY FOR CARGO AND FIGHTER CLASS AIRCRAFT
Ayden Craig, Seenith Sivasundaram, Yungkul Kim
Embry Riddle Aeronautical University
28. A TAXONOMY OF CRITICAL INFRASTRUCTURE VULNERABILITIES: CASE STUDY APPROACH ON SCADA SYSTEMS
Jenisha Khanal, Ashley Newsome
University of Tampa
29. PARALLELS IN THE SECULARIZATION OF EARLY TWENTIETH CENTURY GOSPEL MUSIC AND STAINED GLASS
Anneliese Hardman
Palm Beach Atlantic University
30. USING FNIRS TO STUDY COLLEGE STUDENTS' READING STRATEGIES
Jesse Macyczko, Sabrina Greene, Daniel L. Dinsmore, Katherine C. Hooper
University of North Florida

Poster Session III

31. GENERATION OF A DIFLUOROMETHYLORNITHINE (DFMO) RESISTANT CELL LINE IN A POLYAMINE DEPLETION STRATEGY
Neaba Nouredine, Kelsey Stadnikia, Kristofer Henderson, Sanjeev Koopal, Andreas Enqvist
University of Central Florida
32. EXPRESSION AND LOCALIZATION OF FOXI3 IN CLINICAL MURINE TUMOR MODELS
Ronald Young, Lauren Wiggins, Rashmee Silwal, Amy Koch, Laurie McCauley, Lorenz Christian Hofbauer, Jaqueline Jones
Troy University
33. MILD & EFFICIENT CS₂CO₃-PROMOTED SYNTHESIS ON SOLID PHASE
Lucas S. Kline, Ralph N. Salvatore
Southeastern University
34. EVALUATION OF THE MECHANICAL PROPERTIES OF EPOXY REINFORCED BY CARBON NANOTUBES
Olivia Bray, Grant Bevill, Stephen Stagon
University of North Florida
35. WEAPON-RELATED VIOLENCE IN DUVAL COUNTY, FL AND NATIONWIDE: AN ANALYSIS OF 2017 YOUTH RISK BEHAVIOR SURVEY (YRBS) DATA
Briana Lopez, Camryn Bergeron, Makinlea Dozier, Madisen Reasonover, Judith Rodriguez
University of North Florida
36. NARCISSISM AND PSYCHOLOGICAL WELL-BEING
Etiane Navarro, Renato De La Rosea, Ted Cascio
Palm Beach State College
37. THE EFFECTS OF PERPETRATORS OF SEXUAL HARASSMENT ON VICTIMS' HEALTH OUTCOMES
Angelica Maramba, Jennifer Wolff
University of North Florida
38. THE ROLE OF SODIUM AND FAT CONTENT OF THE DIET ON SYSTOLIC AND DIASTOLIC BLOOD PRESSURE AND PULSE IN MALE WISTAR RATS
Leila Ninya, Alireza Jahan-Mihan
University of North Florida
39. CANNABIDIOL (CBD) KNOWLEDGE, ATTITUDES, AND BEHAVIORS AMONG YOUNG ADULTS
Meghann Wheeler, Julie Williams Merten, Benjamin Gordon, Andre Resto, Jennifer Henderson, Carmen Smotherman
University of North Florida
40. THE IMPACT OF OCEAN PLASTIC CONCENTRATIONS ON SMALL PLASTIC ABUNDANCE AT FLORIDA BEACHES
Elizabeth Harris, Shelby McKeever, Erika L. Doctor, Alanna Lecher
Lynn University
41. DOES MENTAL STATUS MODERATE THE RELATIONSHIP BETWEEN TRAUMATIC BRAIN INJURY HISTORY AND LIFE SATISFACTION?
Charlotte Amelia Payne
University of Central Florida
42. STEREOTYPES OF MAJOR AND NON-MAJOR POLITICAL PARTIES
Katie Locke, Michelle Powell, Elizabeth R. Brown, Curtis E. Phills
University of North Florida
43. CORROSION-FATIGUE BEHAVIOR OF BIOCOMPATIBLE METALS: A REVIEW
Timothy DelCharco, Jutima Simsiriwong
University of North Florida
44. CHARACTERIZATION OF IRON LOADING IN THE HEPCIDIN KNOCKOUT RAT
Savannah Nelson
University of Florida
45. MUSEUM MAGIC: ENHANCING THE MUSEUM EXPERIENCE
Molly Walters, Anna DeJonge
Florida State University
46. VOLATILITY SHOCKS? ANOTHER LOOK AT OIL PRICE PASS-THROUGH
Kyle Cohen
University of North Florida

Poster Session III

47. URBAN LANDSCAPE FEATURES AFFECT PATTERNS OF CO-OCCURRENCE OF THE RED IMPORTED FIRE ANT (*SOLENOPTIS INVICTA*) AND THE ARGENTINE ANT (*LINEPITHEMA HUMILE*)
Abigail Pierre, Joshua King
University of Central Florida
48. ACCESSIBLE CLASSICS: DIGITAL ADAPTATIONS FOR PEOPLE WITH READING DIFFICULTIES
Maria Angeles Fernandez Cifuentes, Teri Pepitone, Harth Schallen
University of North Florida
49. AN EXPLORATION OF THE RELATIONSHIP BETWEEN BRAND ENDORSEMENT OF POLITICAL CANDIDATES/CAUSES AND CONSUMER ATTITUDES AND BEHAVIORS TOWARD THE BRAND
Erin W. Burrows
Florida Southern College
50. GOT MILK? THE DIFFERENTIAL EFFECT OF HUMAN-MILK OLIGOSACCHARIDES IN BREAST AND FORMULA MILK *BIFIDOBACTERIUM INFANTIS*
Paula Sinche
University of North Florida
51. PARENTAL ATTACHMENT, INTOLERANCE OF UNCERTAINTY, AND ERROR-RELATED NEGATIVITY: THREE PROPOSED RISK FACTORS FOR COLLEGE STUDENT SUICIDAL IDEATION
Kayla Wagler, Austin Gallyer, Thomas Joiner
Florida State University
52. INVESTIGATING ROLE OF FC SIGNALING IN NEURODEGENERATIVE PROTEINOPATHIES
Elsa Gonzalez De la Cruz, Lindsay Fadel, Maria Yaroshenko, Pedro E. Cruz, Timothy Machula, Danny Ryu, Paramita Chakrabarty
University of Florida
53. "I BRING NOT PEACE, BUT A SWORD": RELIGION AND REVOLUTIONARY VIOLENCE
John Kelsay, Madelyn Johnson, John Lystad, Payton Parkin
Florida State University
54. LARGE ANTS DON'T CARRY THEIR FAIR SHARE: MAXIMAL LOAD CARRYING PERFORMANCE OF LEAF-CUTTER ANTS (*ATTA CEPHALOTES*)
Ebony D. Taylor, Paolo S. Segre
University of Florida
55. CHARACTERIZING 2,5-DIKETOPIPERAZINES PRODUCED BY A CYCLODIPEPTIDE SYNTHASE ENZYME FROM *STREPTOMYCES*
Jordan S. Phillipps, Amy L. Lane
University of North Florida
56. BARRIERS TO BELONGING: HOW STUDENTS WITH DISABILITIES EXPERIENCE COLLEGE LIFE
Samantha Grossman
University of North Florida
57. IT'S A WOMAN'S WAR TOO: DOLLY MADISON LETTERS AS SITES OF MEMORY FOR PERSONAL AND PROFESSIONAL EXPERIENCES IN WORLD WAR II
Emma Davis
Florida State University
58. IDENTIFICATION OF VECTORS, PARASITES, AND ENDOSYMBIONTS USING PCR AND SEQUENCE ANALYSIS
Michael Alpert, Nicole Butler, Amy Hallock, Brinley Rogers, Jennifer Bess, John Whitlock
Hillsborough Community College
59. DETECTING AXION-LIKE PARTICLES THROUGH GAMMA RAY PHOTONS PRODUCED BY INTERACTIONS WITH THE SUN'S MAGNETIC FIELD
Amarylis Sanchez, John W. Hewitt, Christopher M. Kelso
University of North Florida
60. DATA MINING TO HELP FOSTER CHILDREN
Daniel Oldham, Mihhail Berezovski
Embry Riddle Aeronautical University
61. DETERMINING THE MECHANISM OF AGMATINE DEIMINASE FOR ANTIBIOTIC RESISTANCE IN *CAMPYLOBACTER JEJUNI*
Amarildo Cimo, Bryan Knuckley
University of North Florida

Poster Session III

62. OBESITY IN FLORIDA: POVERTY'S ROLE IN HEALTH OUTCOMES
Alana Innerbichler
University of North Florida
63. CHICANA DOCTORAL STUDENTS IN THE ACADEMY
Kelly Ramirez, Ashley Rosado
Florida State University
64. OPTIMIZING THE CONCENTRATED SOLAR POWER PLANT OF MIDELT
Adil Riahi
University of Central Florida
65. IS SEMEIOSIS REAL?
Stephen Houchins
University of North Florida
66. THE RELATIONSHIP BETWEEN POSITIVE AND NEGATIVE AFFECT AND PSYCHOLOGICAL WELL-BEING
Tracy Doering, Ted Cascio
Palm Beach State College
67. REDIRECTION OF RNA-NANOPARTICLES TO LYMPHOID ORGANS ENHANCES ANTITUMOR IMMUNITY
Adam Grippin, Brandon Wummer, Elias Sayour, Jon Dobson, Duane Mitchell
University of Florida
68. LIONFISH (PTEROIS VOLITANS) POPULATION DENSITY IN TWO DIFFERENT ECOSYSTEMS IN SAN SALVADOR, BAHAMAS
Bianca Wong Rodriguez, Ashlyne Miller, Drake Milligan, Jeremy Stalker, Melinda Simmons
Jacksonville University
69. INTERIOR GEOGRAPHY: EXPLORING SPACE AND MIXED MEDIA IN CERAMIC WALL ART
Mark Lester, Trevor Dunn
University of North Florida
70. ROTATING-BENDING FATIGUE BEHAVIOR OF STAINLESS STEEL 316L
Ross Wykoff
University of North Florida
71. ACETYLCHOLINESTERASE AND VX: USING GIBBS FREE ENERGY TO INCREASE THE EFFICIENCY OF ACETYLCHOLINESTERASE REACTIVATORS
Victoria Li, Erick Aitchison, Wei Yang
Florida State University
72. EFFECTS OF DIETARY RESTRICTION ON THE ORGANISMAL OXIDATION OF LEUCINE IN GRASSHOPPERS
Eugene Rehfeldt, Amra Karjasevic, Sahil Patel, Danielle Hiatt, Marshall McCue, John Hatle
University of North Florida
73. UNDERSTANDING REGULATORY PROTEIN GALECTIN-3 FUNCTION THROUGH POLYMER CONJUGATION
Ling Lin, Hailie Lower, Amanda Pritzlaff, Daniel A. Savin
University of Florida
74. DETERMINING THE GENETIC RELATIONSHIP OF SYMPATRIC CROAKER (MICROPOGONIAS SPP) INHABITING THE INDIAN RIVER LAGOON
Bridget Vincent, Adam Searles, Alexa Trujillo, Rich Paperno, Douglas Adams, Geoffrey Cook, Eric Hoffman
University of Central Florida
75. UNDERSTANDING DYNAMIC MOVEMENTS
Hunter Kemmerer, Sydney Innes, Brandon Roche, Moriah Irizarry, Kaitlyn Newman
Florida Gulf Coast University
76. OBESITY AND BODY SIZE SATISFACTION IN AA GIRLS
Tatyanna Aviles-Wilcher, Frances Breanna McDonald, Sam Ronderos, Dawn Witherspoon
University of North Florida
77. AN APPLICATION OF STATISTICAL LEARNING METHODS TO THREAT ANALYTICS PROBLEMS IN ENTERPRISE NETWORKS
Jared Stiles
University of North Florida

Poster Session III

78. PERSONALITY CHARACTERISTICS AND STUDY CHOICES
Melissa Lehman, Max Casper
Lynn University
79. AXL IS A NOVEL THERAPEUTIC TARGET TO INHIBIT CANCER METASTASIS
Tiffany Le, Mai Tanaka, Samantha S. Dykes, Dietmar W. Siemann
University of Florida
80. ANALYSIS OF DUVAL COUNTY AND NATIONAL 2017 YRBS AVERAGES ON E-CIGARETTES PURCHASED FROM STORES, CURRENTLY USED, AND USE BETWEEN GENDERS OF HIGH SCHOOLERS
Lauren Young, Patrick Healy, Judy Rodriguez
University of North Florida
81. DO AMERICANS FEEL COMFORTABLE WITH THE ADVANCEMENTS IN SELF-DRIVING CAR TECHNOLOGY?
Julia Gaglio, Laura Bautista
Florida Atlantic University
82. RENEWABLE WIND ENERGY ANALYSIS CONSIDERING DIURNAL WIND CYCLES AND EL-NINO SOUTHERN OSCILLATION ALONG THE GULF OF MEXICO AND EASTERN FLORIDA COASTLINES
Spencer Lowery, Justin Stow, Shawn R. Smith, Mark A. Bourassa
Florida State University
83. AN EXAMINATION OF PROSTITUTION: EFFECTS OF CURRENT LAWS, INTERNATIONAL COMPARISONS, AND POLICY IMPLICATIONS FOR DECRIMINALIZATION
Darci Pelham
University of North Florida
84. USING MOBILE LEARNING TO TEACH SPANISH VOCABULARY
Andrew DeMil, Alysha Assaf
The University of Tampa
85. SOCIAL CONFORMITY IN SEXUAL HARASSMENT PUNISHMENT SELECTION IN THE WORKPLACE
David Gavin, Pippa Robertson Burnett, Leilani B. Goodmon, Charlie Law
Florida Southern College
86. INDUCTION OF ANTI-INFLAMMATORY ACETYLCHOLINE RECEPTORS ON HUMAN MACROPHAGES PRODUCED IN THE LABORATORY AS A MODEL SYSTEM FOR DRUG SCREENING AND DEVELOPMENT
Veronica Hartmann, Stefan Basilio, Patricia Keating, James X. Hartmann, Alberto Padilla
Florida Atlantic University
87. THERMAL STUDIES OF SINGLE-MOLECULE MAGNET POLYMERS
Brandon Ol'Laughlin
University of North Florida
88. DEVELOPMENT OF A THREE-DIMENSIONAL WIND MEASUREMENT SOLUTION HOSTED ON A SMALL UNMANNED AERIAL SYSTEM
Christopher Swinford, Kevin A. Adkins, Anthony Oreo
Embry Riddle Aeronautical University
89. USING BIOSTATISTICS CLASS TO TRANSLATE DATA INTO INFOGRAPHICS: FACULTY AND STUDENT PERSPECTIVES
Hope Michael, Gabrielle Maiolo, Mary Martinasek
The University of Tampa
90. ALTRUISTIC PERSPECTIVE OF YOUNG ADULTS INTEREST IN CSR VOLUNTEERING
CeeCee Davis
Tallahassee Community College; Troy University

Poster Session III

91. IS THIS A GOOD IDEA? HOW FOLLOWER PERCEPTION OF LEADERS INFLUENCES ENDORSEMENT OR REJECTION OF LEADER IDEAS
Robert Brinson, Bailey Kleindienst, Samantha Kaye, Dale Peterson, Parker Webb, Amy Sheffield, Randall Croom, Areti Vogel
Stetson University
92. VOLUNTEER TOURISM IN COSTA RICA
Claire Hoeschele, Ronald Lukens-Bull, Anne Pfister
University of North Florida
93. PRESERVATION PROJECT JACKSONVILLE: THE UNTOLD STORY
Kaley Crawford, Reilly Cassel
University of north Florida

Poster Session IV

1. CLONING, FUNCTIONAL EXPRESSION, AND CHARACTERIZATION OF NOVEL SER/THR KINASE, STK 3169 OF ANABAENA PCC 7120 FOR PHOSPHORYLATION ROLE IN SIGNALING
TraceyAnn Matthie, Aakriti Gautam, Vishwa D. Trivedi
Bethune-Cookman University
2. DIFFERENCES IN DRUG AND ALCOHOL USE BETWEEN HIGH SCHOOL MALES AND FEMALES IN DUVAL COUNTY ACCORDING TO THE 2015 AND 2017 YRBS
Tamar Gorham, Bailey Pace, Becky DeVincenzo
University of North Florida
3. KICK (REMOTE PREGNANCY MONITOR)
Alona Basko, Danielle Gray, Waseem Asghar
Florida Atlantic University
4. INHIBITION OF HYDROGEN SULFIDE PRODUCTION BY FAT BODY OF LUBBER GRASSHOPPERS
Stephenie Dilts, Damir Sarajilic, Evan Judd, John Hatle, Cathy Peterson
University of North Florida
5. CEREBROVASCULAR RISK FACTORS AND STATUS OF COLLATERAL FLOW IN ACUTE EMBOLIC STROKE
Emily McCoy, George K. Vilanilam, Mohammed K. Badi, Caitlin D'Souza, Tara Becker, Vivek Gupta
Florida State University
6. TRENDS IN REPORTING SEXUAL ASSAULT AND INTERPERSONAL VIOLENCE AT A DEAF UNIVERSITY
Danielle Dorn, Tyler G. James, Julia R. Varnes
University of Florida
7. THE LINK BETWEEN SOCIOECONOMIC STATUS (SES) AND SUICIDE MORTALITY
Madison Meyer
University of North Florida
8. RAPID AND EFFICIENT METHOD FOR THE REDUCTION OF QUINOXALINES USING LIBH4 AND CH3I: SYNTHESIS OF 1, 2, 3, 4-TETRAHYDROQUINOXALINES
Reed W. Roberts, Ralph N. Salvatore, Terrence E. Gavin
Southeastern University
9. THE ROLE OF TETRASPANIN CD9 IN EXTRACELLULAR VESICLE BIOGENESIS AND TRAFFICKING
Leanne Duke
Florida State University
10. ALTERNATIVE SYNTHETIC PATHWAY IN TOTAL SYNTHESIS OF THE TUMOR-ASSOCIATED THOMSEN-FRIEDENREICH (TF) CARBOHYDRATE ANTIGEN
Mary Minore, William Miranda, Mare Cudic
Florida Atlantic University
11. THE 'UNPLAYED' LEVEL: A LINK BETWEEN MODALITY AND VIDEO GAME THEMES IN SUPER MARIO GALAXY
Gabrielle Goral
Florida Gulf Coast University
12. FIGHTING FIRE V. HUNTING TREASURE: EXAMINING HOW CONTEXT AFFECTS DECISION MAKING
Elena Sakosky, Stephen Blessing, Geoff Engelstein
The University of Tampa
13. UNDERSTANDING THE HEALTH CARE EXPERIENCES OF DEFERRED ACTION FOR CHILDHOOD ARRIVALS (DACA) RECIPIENTS
Jacob Kluesener, Laura Gonzalez
University of Central Florida
14. SOCIAL ANXIETY AND SUBTYPES OF EMPATHY: THE MODERATING INFLUENCE OF BIOLOGICAL SEX
Samantha Berg, Jeffrey Bedwell, Erin Tone
University of Central Florida

Poster Session IV

15. TIMESCALES OF GLOBAL TIDAL FLOODING
Maria Bower, Thomas Wahl
University of Central Florida
16. MATCHING COGNITIVE FACTORS' IMPACT ON JOB PERFORMANCE
Hannah Ji, Lisa Hinson
University of Florida
17. PROTEIN DISULFIDE ISOMERASE INHIBITS AND REVERSES ALPHA-SYNUCLEIN FIBRILLIZATION
Joey Ragusa, Baggio Evangelista, Albert Serrano, Xin Qiao, Yoon-Seong Kim, Bo Chen, Ken Teter
University of Central Florida
18. PRODUCTION AND CHARACTERIZATION OF 2,5-DIKETOPIPERAZINES PRODUCED BY THE CYCLODIPEPTIDE SYNTHASES
Paul Borgman, Amy Lane
University of North Florida
19. MILD AND EFFICIENT SYNTHESIS OF PHOSPHANE-CARBODITHIOATES VIA A THREE-COMPONENT COUPLING REACTION OF A PHOSPHINE, CARBON DISULFIDE, AND AN ALKYL HALIDE
Marilyn O. Ikhane, Hyelsinta J. Danboyi, Lisette E. Victorio, Mark E. Steury, Ralph N. Salvatore
Southeastern University
20. EXPLORING THE PORTRAYALS OF MODERN FIRST LADIES IN CHILDREN'S PICTUREBOOK BIOGRAPHIES
Kaitlin Elmore
University of Central Florida
21. DEPRESSION AND ANXIETY'S INDEPENDENT EFFECTS ON HYPERTENSION AND HYPERLIPIDEMIA
Ana Caballero
Florida State University
22. CHARACTERIZATION OF THE IMMUNE PROPERTIES OF MOUSE NEURAL RETINA EXTRACTS
Ashton N. Ray, Judith D. Ochrietor
University of North Florida
23. BEYOND THE TRAIL: A RIVER RUNS THROUGH IT
Katie Vearil
University of North Florida
24. SOCIAL MEDIA'S AFFECT ON SELF ESTEEM
Daphnie Dilus, Jazmin Velasco
Florida Atlantic University
25. CHARACTERIZATION OF FC-DRIVEN NK CELL EXPANSION AND PHENOTYPE SHAPING
Raquel Arthuzo, Jeremiah Oyer, Namita Varudkar, Griff Parks, Alicja Copik
University of Central Florida
26. EXPLORING THE RELATIONSHIP BETWEEN ATTITUDES ABOUT MENTAL ILLNESS, ABOUT GUNS, AND PERSONALITY VARIABLES
Rachel Chavez, Karen Mottarella, Shannon Whitten
University of Central Florida
27. HOW HIV DIAGNOSING RATES ARE AFFECTED BY VARIOUS SOCIAL IDENTITIES IN THE UNITED STATES OF AMERICA FROM 2010-2013
Blaise Guerriero
The University of Tampa
28. STANDING UP OR GIVING UP? MORAL FOUNDATIONS SHAPE EVALUATIONS OF PROTESTS
Isaac Richardson
Florida State University
29. ACUTE INTERMITTENT HYPOXIA AND BASAL THERMAL SENSITIVITY
Taylor Maderazo, Soofia Hameed-Akhtar, Andrew Dashiell, Regina Camberos Rios, Jenna Levin, Abigail Wilson, Shakeel Ahmed, Joel Bialosky, Mark Bishop
University of Florida
30. THE ROLE OF TETRASPANIN CD9 IN EXTRACELLULAR VESICLE BIOGENESIS AND TRAFFICKING
Leanne Duke
Florida State University

Poster Session IV

31. MUTAGENIC POTENTIAL OF BPA ALTERNATIVES ON MOUSE FIBROBLAST AND NEURONAL CELLS IN VITRO
Megan Rizer, Thomas Dao, James Chang, Emily Bradshaw, Alicia Hawthorne
University of Central Florida
32. AUTOMATED CELL STRETCHING DEVICE FOR MECHANOBIOLOGY EXPERIMENTS
Myra Kurosu Jalil, Justin Keister, Anthony Yin, Chelsey Simmons
University of Florida
33. CHARACTERIZATION OF METABOLIC GENE EXPRESSION IN MOUSE CORNEA
Sommar Asfoura, Jim Gelsleichter, Judith D. Ochrietor
University of North Florida
34. AMERICAN CATHOLICISM STRAINS RELIGIOUS THEORY
Michael Joseph Augustine
University of North Florida
35. HU SHIH'S "HOW I WENT ABROAD" AND "ARRIVING IN THE UNITED STATES" AND CHINESE STUDY ABROAD EFFORTS IN THE LATE 19TH AND EARLY 20TH CENTURY
Tatum Shannon
Florida State University
36. TOWARDS NANOSTRUCTURED SENSORS IN THE REAL WORLD: PLASMONIC PROPERTIES OF TRANSITION METAL NITRIDES
Neil Blaser, Peter Bohn, Lev Gasparov, Stephen Stagon
University of North Florida
37. TRACKING THE INITIAL ONSET OF DEOXYGENATION ACROSS THE PALEOCENE-EOCENE THERMAL MAXIMUM
Jane Wadhams, Jeremy Owens, Theodore Them
Florida State University
38. STEREOTYPES OF MAJOR AND NON-MAJOR POLITICAL PARTIES
Katie Locke, Michelle Powell, Elizabeth R. Brown, Curis E. Phills
University of North Florida
39. PINE NEEDLES DISSIPATE RAINFALL ENERGY VIA HIGHLY INTERDEPENDENT DYNAMICS
Amy Lebanoff, Andrew Dickerson
University of Central Florida
40. REPRODUCTIVE ENDOCRINOLOGY OF THE ATLANTIC SHARPNOSE SHARK, RHIZOPRIODON TERRAENOVAE, OFF THE COAST OF NORTHERN FLORIDA
Halee Larson, Jim Gelsleichter
University of North Florida
41. DYNAMIC DECISION-MAKING PROCESS IN TWO DIFFERENT TASKS ACROSS CULTURES
Yoannis Hermida, Willow Clem, Dominik Guess
University of North Florida
42. SORRY, NOT SORRY: A TEXTUAL ANALYSIS OF CORPORATE APOLOGIES
Bailey Kleindienst
Stetson University
43. THE ROLE OF WNT 4 AND WNT 5 IN TARDIGRADE BODY PLAN EVOLUTION
Zachary Snow, Frank W. Smith
University of North Florida
44. WHAT HAPPENS ONCE MAY HAPPEN AGAIN: VISUAL SENSORY GATING OF FAMILIAR STIMULI
Mason Rademaker, Jessica Simon, Destiny Carbello
Florida State University
45. A PICTURE IS WORTH A THOUSAND WORDS: IMAGES OF NAZI PROPAGANDA IN YOUTH LITERATURE
Emily Akers
University of South Florida St. Petersburg

Poster Session IV

46. EFFECTS OF COCAINE ON PRIMARY CILIA LENGTH ON DOPAMINERGIC NEURONS IN THE VENTRAL TEGMENTAL AREA AND NUCLEUS ACCUMBENS
Ally Firek, Kalene Jasso, Craig Meyers, Jeremy McIntyre
University of Florida
47. MULTIPLE WEAPON MORPHS IN THE LEAF FOOTED BUG THASUS NEOCALIFORNICUS
Robert Entzian, Zachary Emberts, Colette M. St. Mary, Christine W. Miller
University of Florida
48. EXAMINATION OF ASSOCIATIONS BETWEEN LCD SCORE AND PROGNOSTIC FACTORS AMONG U.S. ADULTS WITH TYPE 2 DIABETES: AN ANALYSIS OF THE NHANES (2005-2016)
Elta Charles, Eunkyung Lee
University of Central Florida
49. POLITICAL AFFILIATION AND THE PREJUDICE IT CREATES IN THE NFL PROTEST
Geoffrey Stephen, Tariq James
Florida Atlantic University
50. TREATMENT APPROACHES FOR ORAL MUCOSITIS
Lisseth Quijano, Siddarth Kesharwani, Sonali Pandey, Foram Madiyar
Embry Riddle Aeronautical University
51. CHALLENGES IN HYPERTENSION AND STROKE IN HAITIANS: LIFESTYLE AND HEALTH RISKS IN DIET
Kisha Cadet, Tania Reynolds
Florida State University
52. EXAMINING ZOOPLANKTON DENSITY RELATED TO SEASONAL AND WATER QUALITY CONDITIONS IN THE HALIFAX RIVER LAGOON, FL
Lakean McGregor, Sarah Krejci
Bethune-Cookman University
53. SPARK PLASMA SINTERED ALUMINUM OXIDE FILTER FOR HOT GAS APPLICATIONS
Catalina Young, Cheng Zhang, Arvind Agarwal
Florida International University
54. BEYOND THE BREAK-UP: LEARNING FROM THE DISSOLUTION OF A GRANTMAKING COLLABORATION
David Berlan, Megan Grenville, Lauren Moran, Luciana Polischuk, Molly Rimes
Florida State University
55. DIFFERENCES IN WEIGHT PERCEPTIONS AND BEHAVIORS BETWEEN DUVAL COUNTY, FL AND NATIONAL HIGH SCHOOL STUDENTS ACCORDING TO THE 2015 YOUTH RISK BEHAVIOR SURVEY (YRBS) DATA
Julia Gannaway, Elizabeth Mclean, Cassandra Branham, Judith Rodriguez
University of North Florida
56. CASH-FREE ECONOMY: THE RELATION BETWEEN AGE AND ONLINE MONEY ACTIVITY
Elisa Gomes, Shaina Rubin
Florida Atlantic University
57. BUDDHISTS AS PERPETRATORS: STATE IDEOLOGY VS. RELIGIOUS IDEOLOGY IN MYANMAR
Hailee Clark
Embry Riddle Aeronautical University
58. ANALYSIS OF TEMPORAL AND SOCIOECONOMIC EFFECTS ON Aedes albopictus WING LENGTH
Emily K. Stone, Gabriela Hamerlinck, Stephanie J. Mundis, Ari Whiteman, Sadie J. Ryan
University of Florida
59. THE EFFECTS OF FACEBOOK USE ON COGNITION AND EMOTION IN COLLEGE STUDENTS: POSITIVE REFLECTION GROUP
Hannah Buzbee, Gina Marie Weis, Adam Barrett-Clarke, Michael Stasio, Erin Koterba, Erica Yuen
The University of Tampa
60. SECULAR AND RELIGIOUS SPACE IN AMERICAN POLITICS
Taylor Cook
University of North Florida

Poster Session IV

61. EXAMINING THE EFFECTS OF SCREEN SIZE ON ARCHAEOLOGICAL DATA COLLECTION
John McDowell, Jack Meyers, April Watson, Alana Leacher
Lynn University
62. THE IMPACT OF LIVING IN A RURAL COMMUNITY ON RESIDENTS ACCESS TO ADEQUATE HEALTHCARE
Roshanda Hodges
Troy University
63. A PRELIMINARY STUDY ON THE DIVERSITY OF EPIFAUNA ON LEPTOGORGIA VIRGULATA TAMPA BAY, FL
Haley Lasco, John Ambrosio, Wayne Price, Michael Middlebrooks
The University of Tampa
64. UNDERSTANDING DYNAMIC MOVEMENTS
Hunter Kemmerer, Sydney Innes, Brandon Roche, Moriah Irizarry, Kaitlyn Newman
Florida Gulf Coast University
65. A TRANSCRIPTOMICS AND FUNCTIONAL GENETICS APPROACH TO IDENTIFYING COMPONENTS OF THE DROSOPHILA POLYAMINE TRANSPORT SYSTEM
Joanne Saldanha, Michael Haney, Brianne Landry, Natalia Figueroa, Laurence von Kalm
University of Central Florida
66. SIZE AND SUSTAINABLE AGRICULTURE IN FLORIDA FARMS
Meylin Muniz, Masanori Fujimoto
University of Florida
67. USING GREEN CHEMISTRY FOR THE CATALYTIC REMOVAL OF TOXIC MERCURY FROM FLUE ASH THROUGH ADVANCE OXIDATION TREATMENT
Zachary Loeb, Anwar Sadmani
University of Central Florida
68. THE EFFECTS OF BD METABOLITES ON FRESHWATER INVERTEBRATES
Sarah E. Detmering, Taegan A. McMahon, Caitlin L. Nordheim
The University of Tampa
69. MILD AND EFFICIENT SYNTHESIS OF AMIDES FROM ACID CHLORIDES AND AMINES USING CESIUM BASES
Joseph Shamp, Ethan Carey, David Orlando, Ralph N. Salvatore
Southeastern University
70. BORROWING TIME: TRANSFERENCE AND TRANSFORMATION IN MODERNIST AND CLASSICAL POETRY
Nicholas Odom
University of Central Florida
71. PARENTS REACHING BEYOND CEREBRAL PALSY
Essie Russell
Troy University
72. ALZHEIMER'S
Lillie Thompson Smith
Troy University
73. SCREEN PRINTING PROCESSES ON CERAMICS AT CONE 10 ATMOSPHERIC CONDITIONS
Charlie Cartwright, Andrew Kozlowski
University of North Florida
74. MORAL DEMAND, MORAL IDENTITY, AND THE EMPATHY-ALTRUISM RELATIONSHIP
David N. Hall, Robert Askew
Stetson University
75. SIGNIFICANCE OF CYTOPLASMIC DOMAIN OF RECEPTOR AND MODULATION OF RECEPTOR BINDING VIA HELICAL FACE OF ANABAENA SENSORY RHODOPSIN TRANSDUCER, ASRT
Shenequa Davis, Dominique Hale, Aakriti Gautam, Vishwa Trivedi
Bethune-Cookman University

Poster Session IV

76. MATHEMATICAL MODELING ANALYSIS OF LONGITUDINAL CONTROL AND STABILITY FOR CARGO AND FIGHTER CLASS AIRCRAFT
Ayden Craig, Seenith Sivasundaram, Yungkul Kim
Embry Riddle Aeronautical University
77. CONSTRUAL LEVEL
Dale Peterson, Robert Brinson, Bailey Kleindienst, Nathan Wyche, Mark Hodae, Samantha Kaye, Randall Croom, Kelly Hall
Stetson University
78. THE INVOLVEMENT OF NA/K-ATPASE SIGNALING IN REGULATION OF BLOOD PRESSURE BY HEME OXYGENASE-1
Michelle A. Germeil, Yanling Yan, Jiang Liu, Joseph I. Shapiro
Bethune-Cookman University
79. THE EFFECTS OF TEMPERATURE ON THE IMMUNE FUNCTION OF DIAPHORINA CITRI AND ITS ABILITY TO VECTOR HAUNGLONGBING
Lindsay Martin, Thaila Schug, Kenneth Fedorka
University of Central Florida
80. A SURVEY OF THE ARTHROPOD SPECIES IN GOPHERUS POLYPHEMUS BURROWS AT THE FAU PRESERVE HABITATS
Lauren Melanson, Evelyn Frazier
Florida Atlantic University
81. REIMAGINING DRUGS: AN ANTHROPOLOGICAL ANALYSIS OF U.S. DRUG POLICY FRAMEWORKS AND STUDENT ACTIVISM
Megan Sarmiento
University of Central Florida
82. THE INFLUENCE OF DECAY AND ANGER SUPERIORITY ON CHANGE BLINDNESS
Renee Pack, Leilani B. Goodmon
Florida Southern College
83. AVERAGE SLEEP AND GPA
Kristin Trainer
Florida Gulf Coast University
84. DEGRADATION OF DISEASE CAUSING NON-CODING RNAS USING SMALL MOLECULE RECRUITMENT OF A NUCLEASE
Christy W. LaFlamme, Matthew G. Costales, Matthew D. Disney
Florida Atlantic University
85. "I CAN DO BAD ALL BY MYSELF": THE COST OF STRONG BLACK WOMAN SCHEMA ENDORSEMENT
Stephanie Castelin, Grace White
University of Central Florida
86. INVESTIGATING RELATIONSHIPS BETWEEN HYPERTENSION, SLEEP, AND COGNITIVE RISKS IN RURAL, ETHNICALLY - DIVERSE COHORT
Princess Maryam Abdul-Akbar, Lisa Kirk Wiese
Florida Atlantic University
87. PERCEIVED INTENTIONALITY VIA KINEMATICS
Jordan Sasser, Daniel McConnell, Peter Hancock
University of Central Florida
88. NEIGHBORHOOD CHANGE IN FRENCHTOWN, TALLAHASSEE
Allison Bloomer, Douglas Allen
Florida State University
89. HOW QUICK SERVICE RESTAURANTS AMPLIFY THEIR PRODUCTS AS DELICIOUS BUT MUTE UNHEALTHFUL CONSEQUENCES OF THEIR FOOD
Sierra Perry
Bethune-Cookman University
90. SOCIOLOGICAL PERSPECTIVES ON THE PHASES OF EMERGENCY MANAGEMENT FOR HURRICANE MARIA IN PUERTO RICO
Jose Rivera, Fernando Rivera
University of Central Florida
91. LIVESTOCK ASSOCIATED ANTIBIOTIC RESISTANT BACTERIA
Adam Wong, Matthew Pileggi, John Chase
University of Florida

92. INVESTIGATION OF THE DIFFERENCES IN SUBSTRATE SPECIFICITY BETWEEN PRMT1 AND PRMT5 AND THE DEVELOPMENT OF A PRMT1-SPECIFIC CHEMICAL PROBE

Sarah Mann, Corey Causey, Bryan Knuckley
University of North Florida

93. BTW, HOW ARE UNDERGRADUATE STUDENTS USING SOCIAL MEDIA?

Renata Sindicic, Enilda Romero-Hall, Linlin Li
The University of Tampa



PatLaw
UMN

law.umn.edu/PatLaw



FOR YOU

PURSUe YOUR PASSION AND INVEST IN YOU - YOUR CURIOSITY, YOUR SKILLS, AND YOUR DREAMS WITH A GRADUATE DEGREE FROM FORT HAYS STATE UNIVERSITY.

"To anyone who is afraid to make a jump for something they are passionate about, don't be. I know that I'm in a position to land a fantastic career because of the supportive Fort Hays State community."

MELISSA SKELTON
Biology

At FHSU, we appreciate your commitment to graduate studies and match your personal investment with flexible on-campus and online programs, mentorship, financial support, and real-world experience. Choose from over 20 nationally-recognized graduate degree programs and start your journey with us.

Learn more about our programs at FHSU.edu/gradschl/programs



FORT HAYS STATE UNIVERSITY
GRADUATE SCHOOL

Forward thinking. World ready.

Acknowledgements

Dee Crawford	Anirban Ghosh, Ph.D.	Judith Ochrietor, Ph.D.
Kaley Crawford	Jeff Chamberlain, Ph.D.	Shinwoo Choi, Ph.D.
Karen Patterson, Ph.D.	Nilufer Ozdemir, Ph.D.	Helene Vossos, Ph.D.
Katie Sarria	Paul Argott, Ph.D.	Russell Triplett, Ph.D.
Dave Waddell, Ph.D.	Betsy Nies, Ph.D.	Peter Magyari, Ph.D.
Brian Coughlin	Hannah Malcolm, Ph.D.	FURC Board
Amy Lane, Ph.D.	Lindsay Mahovetz, Ph.D.	Bridget Vincent
Ash Faulkner, Ph.D.	James Harvin, Ph.D.	Kaitlyn Minnicks
Katherine Hooper, Ph.D.	Cristy Cummings, Ph.D.	Ava Sambriski
Tara Kelley, Ph.D.	Nuria Ibanez, Ph.D.	Alicia Smith

Graduate School Recruiters

University of Miami	University of Chicago	Embry Riddle Aeronautical University
Florida State University	Bethune-Cookman University	University of South Florida
Florida Atlantic University	Brown School at Washington University in St. Louis	St. Jude Research Hospital
University of South Carolina	Florida International University	Columbia University
Nova Southeastern University	Belmont University	Florida Gulf Coast University
University of North Florida	New York University	Florida International University
University of Alabama at Birmingham	University of Illinois at Urbana-Champaign	University of Florida
Georgia State University	Delta State University	Coastal Carolina University
University of Central Florida	Lynn University	University of Florida Health Cancer Center
University of Alabama at Huntsville	Purdue University	University of South Florida St. Petersburg
University of Colorado	Fort Hays State University	Barry University
University of California Irvine	University of Notre Dame	University of Minnesota
University of California San Diego		



St. Jude Children's Research Hospital

Graduate School of Biomedical Sciences

Consider an extraordinary PhD program at one of the world's premier research centers for pediatric cancer and childhood disease.

With leading-edge science, unparalleled resources, an immersive clinical experience, our graduate program is designed for research-oriented students who will help discover the next generation of cures.

Throughout your doctoral training, you will be supported with benefits including a generous stipend, exceptional core facilities, and a collaborative, close-knit research environment—all in the heart of the vibrant city of Memphis.

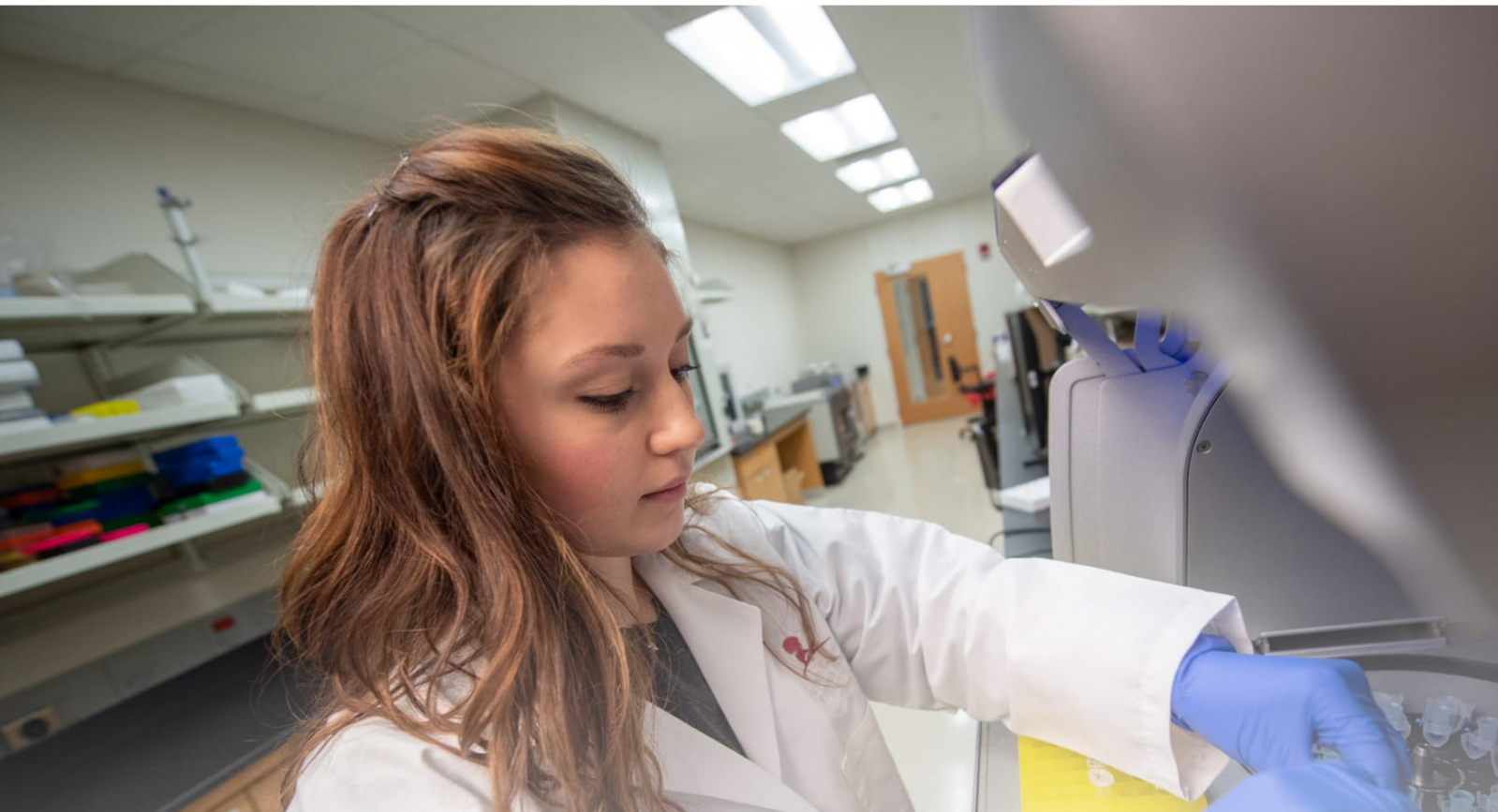
A young woman with long brown hair, wearing a white lab coat and blue gloves, is working in a laboratory. She is looking down at a piece of equipment, possibly a pipette or a small vial. The background shows a typical laboratory setting with shelves, equipment, and a door.

**Applications for the fall 2020 term will open in March 2019.
Deadline is December 1, 2019.**

Explore the Graduate School: stjude.org/graduate-school

Subscribe to our e-newsletter: stjude.org/graduate-school-subscribe

The iSchool at Illinois



Shaping the future of information

Top reasons to choose the iSchool at Illinois

- 1 Top-ranked MS in Library and Information Science
- 2 STEM-designated MS in Information Management
- 3 Customizable 40-credit-hour degree
- 4 Comprehensive academic & career services support
- 5 No GRE or GMAT if GPA is 3.0 or higher*

On-campus and online programs available

- MS in Library and Information Science
- MS in Information Management
- Certificate of Advanced Study
- Doctor of Philosophy (on campus)
- School Librarian Licensure
- Continuing Education

I ILLINOIS

School of Information Sciences

go.ischool.illinois.edu/programs



Florida State University
College of Communication & Information
cci.fsu.edu

MORE THAN A MASTER'S DEGREE

THE KEY TO A SUCCESSFUL CAREER



COMMUNICATION

Integrated Marketing Communication
Media Communication Studies
Public Interest Media Communication

INFORMATION

Information Technology *Online*
Information *Online & ALA Accredited*

COMMUNICATION SCIENCE & DISORDERS

Speech Language Pathology
Ask about our Prerequisite Bridge Program

LEARN MORE
cci.fsu.edu



FURC

FLORIDA UNDERGRADUATE RESEARCH
CONFERENCE

SAVE THE DATE

21-22

FEBRUARY
2020

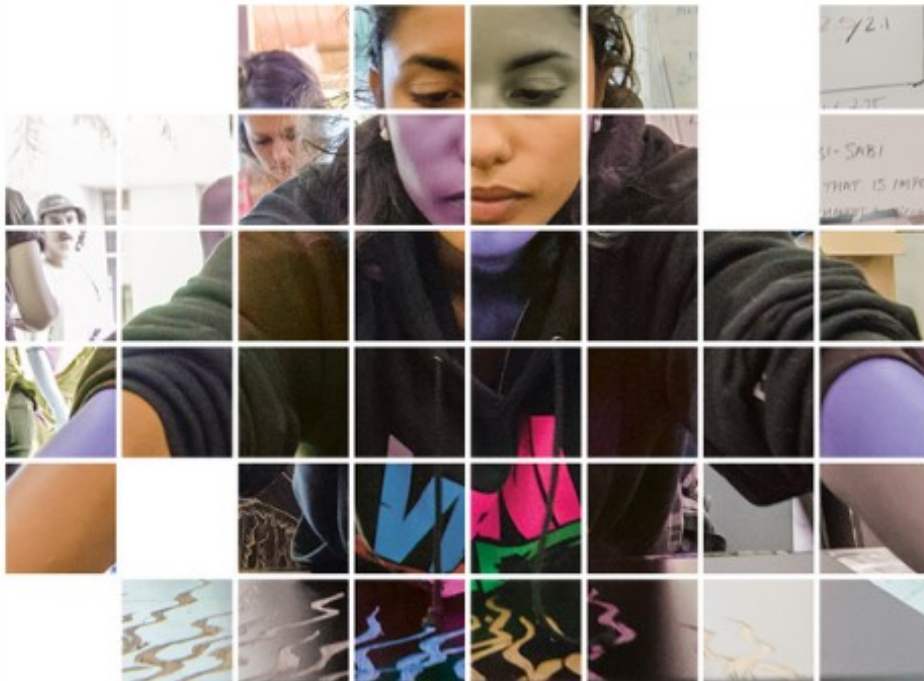

Hosted by **FLORIDA GULF COAST UNIVERSITY**



Workshop Map

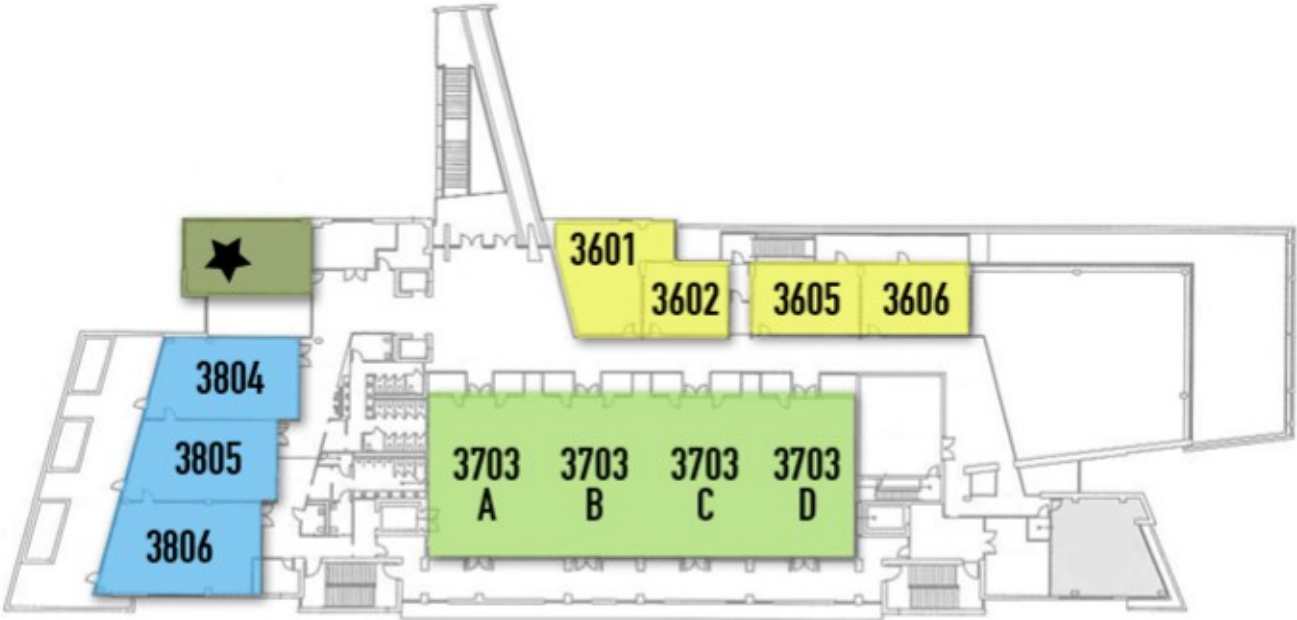

-  Ballroom (3703A-3703D)
-  Small Meeting Rooms (3601-3606)
-  Medium Meeting Rooms (3804-3806)
-  North Star Boardroom

Event Map

[Lot 18](#)

Bus Drop-off

Parking

[Building 26](#)

Main Conference Space

Posters

[Building 58*](#)

Reception

Workshops

Panda Express

[Building 16](#)

Osprey Café



*Building 58 dining is limited to 200 guests. Once at capacity, guests must dine at the Osprey Café, which offers vegan and gluten free options.

Notes

Notes

